

BOX CONNECTOR

[Straight Threads]

A box connector creates a separable termination into a box. This connector has straight threads (NPS) and is supplied with a locknut, O-ring supplied upon request.

Nominal Size	Type	Item No.	D		Weight			
			lbs	kg				
¾	XW	07C-XW-30	1.435	(36)	3	(76)	0.11	(0.05)
1	XW	10C-XW-30	1.700	(43)	3	(76)	0.22	(0.10)
1¼	XW	12C-XW-30	2.045	(52)	3	(76)	0.35	(0.16)
1½	XW	15C-XW-30	2.285	(58)	3	(76)	0.49	(0.22)
2	XW	20D-XW-30	2.520	(64)	5	(127)	0.85	(0.39)
2½	XW	25D-XW-30	3.025	(77)	5	(127)	0.94	(0.43)
3	XW	30D-XW-30	3.520	(89)	5	(127)	1.28	(0.58)
3½	XW	35D-XW-30	4.025	(102)	5	(127)	1.77	(0.80)
4	XW	40D-XW-30	4.520	(115)	7	(178)	2.09	(0.95)
5	XW	50D-XW-30	5.520	(140)	7	(178)	2.75	(1.25)
6	XW	60D-XW-30	6.520	(166)	7	(178)	2.97	(1.35)

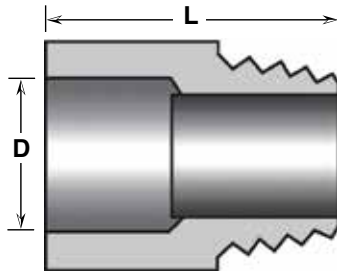

MALE ADAPTER

[Tapered Threads]

Male adapters with tapered threads (NPT) are generally used for joining to female threads of rigid steel, Myers type hubs or terminating into precast iron boxes with female thread entrances.

Nominal Size	Type	Item No.	D		Weight			
			lbs	kg				
¾	XW	07C-XW-33	1.435	(36)	3	(76)	0.09	(0.04)
1	XW	10C-XW-33	1.700	(43)	3	(76)	0.19	(0.09)
1¼	XW	12C-XW-33	2.045	(52)	3	(76)	0.24	(0.11)
1½	XW	15C-XW-33	2.285	(58)	3	(76)	0.35	(0.16)
2	XW	20D-XW-33	2.520	(64)	5	(127)	0.69	(0.31)
2½	XW	25D-XW-33	3.025	(77)	5	(127)	0.85	(0.38)
3	XW	30D-XW-33	3.520	(89)	5	(127)	1.00	(0.45)
3½	XW	35D-XW-33	4.025	(102)	5	(127)	1.28	(0.58)
4	XW	40D-XW-33	4.520	(115)	7	(178)	1.56	(0.71)
5	XW	50D-XW-33	5.520	(140)	7	(178)	2.08	(0.94)
6	XW	60D-XW-33	6.520	(166)	7	(178)	2.47	(1.12)

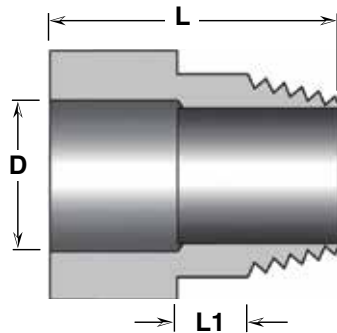

SPECIAL ADAPTER FOR PVC COATED FITTINGS

[Male Terminal Adapter]

This terminal adapter has tapered threads and a straight shoulder so it can fit under the PVC sleeve of a PVC coated steel fitting.

Nominal Size	Type	Item No.	D		L	L1	Weight			
			lbs	kg	lbs	kg				
¾	XW	07C-XW-24	1.435	(36)	3.75	(95)	0.75	(18)	0.36	(0.16)
1	XW	10C-XW-24	1.700	(43)	4.00	(102)	1.00	(25)	0.50	(0.23)
1¼	XW	12C-XW-24	2.045	(52)	4.25	(108)	1.25	(32)	0.60	(0.27)
1½	XW	15C-XW-24	2.285	(58)	4.50	(114)	1.50	(38)	0.90	(0.41)
2	XW	20D-XW-24	2.520	(64)	7.00	(178)	2.00	(51)	0.69	(0.31)
2½	XW	25D-XW-24	3.025	(77)	7.00	(178)	2.00	(51)	1.20	(0.45)
3	XW	30D-XW-24	3.520	(89)	7.00	(178)	2.00	(51)	1.00	(0.45)
3½	XW	35D-XW-24	4.025	(102)	7.00	(178)	2.00	(51)	1.20	(0.54)
4	XW	40D-XW-24	4.520	(115)	7.00	(178)	2.00	(51)	1.56	(0.71)
5	XW	50D-XW-24	5.520	(140)	7.00	(178)	2.00	(51)	2.08	(0.94)
6	XW	60D-XW-24	6.520	(166)	7.00	(178)	2.00	(51)	2.47	(1.12)

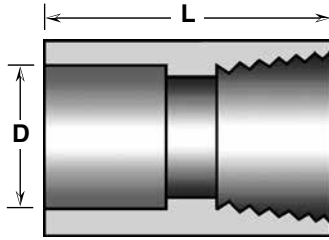

FEMALE TERMINAL ADAPTER

This adapter is generally used for joining fiberglass conduit with galvanized rigid steel (GRS) conduit. It has the same threads as GRS conduit and can easily be attached to GRS conduit.

Nominal Size	Type	Item No.	D	L	Weight lbs kg
¾	XW	07C-XW-32	1.435 (36)	3 (76)	0.30 (0.14)
1	XW	10C-XW-32	1.700 (43)	3 (76)	0.38 (0.17)
1¼	XW	12C-XW-32	2.045 (52)	3 (76)	0.45 (0.20)
1½	XW	15C-XW-32	2.285 (58)	3 (76)	0.60 (0.27)
2	XW	20D-XW-32	2.520 (64)	5 (127)	1.20 (0.55)
2½	XW	25D-XW-32	3.025 (77)	5 (127)	0.85 (0.38)
3	XW	30D-XW-32	3.520 (89)	5 (127)	1.40 (0.64)
3½	XW	35D-XW-32	4.025 (102)	5 (127)	1.28 (0.58)
4	XW	40D-XW-32	4.520 (115)	7 (178)	2.08 (0.94)
5	XW	50D-XW-32	5.520 (140)	7 (178)	2.60 (1.18)
6	XW	60D-XW-32	6.520 (166)	7 (178)	3.51 (1.59)

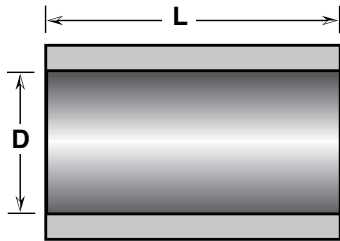

SLEEVE COUPLING

Nominal Size	Type	Item No.	D	L	Weight lbs kg
¾	XW	07C-XW-42	1.435 (36)	6 (152)	0.22 (0.10)
1	XW	10C-XW-42	1.700 (43)	6 (152)	0.29 (0.13)
1¼	XW	12C-XW-42	2.045 (52)	6 (152)	0.36 (0.16)
1½	XW	15C-XW-42	2.285 (58)	6 (152)	0.39 (0.18)
2	XW	20D-XW-42	2.520 (64)	10 (254)	0.88 (0.40)
2½	XW	25D-XW-42	3.025 (77)	10 (254)	1.08 (0.49)
3	XW	30D-XW-42	3.520 (89)	10 (254)	1.25 (0.57)
3½	XW	35D-XW-42	4.025 (102)	10 (254)	1.87 (0.85)
4	XW	40D-XW-42	4.520 (115)	10 (254)	1.50 (0.68)
5	XW	50D-XW-42	5.520 (140)	10 (254)	2.08 (0.94)
6	XW	60D-XW-42	6.520 (166)	10 (254)	2.50 (1.13)

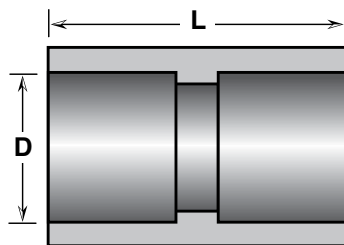

STOP COUPLING

Nominal Size	Type	Item No.	D	L	Weight lbs kg
¾	XW	07C-XW-40	1.435 (36)	6 (152)	0.22 (0.10)
1	XW	10C-XW-40	1.700 (43)	6 (152)	0.29 (0.13)
1¼	XW	12C-XW-40	2.045 (52)	6 (152)	0.36 (0.16)
1½	XW	15C-XW-40	2.285 (58)	6 (152)	0.39 (0.18)
2	XW	20D-XW-40	2.520 (64)	10 (254)	0.88 (0.40)
2½	XW	25D-XW-40	3.025 (77)	10 (254)	1.08 (0.49)
3	XW	30D-XW-40	3.520 (89)	10 (254)	1.25 (0.57)
3½	XW	35D-XW-40	4.025 (102)	10 (254)	1.87 (0.85)
4	XW	40D-XW-40	4.520 (115)	10 (254)	2.00 (0.91)
5	XW	50D-XW-40	5.520 (140)	10 (254)	2.50 (1.13)
6	XW	60D-XW-40	6.520 (166)	10 (254)	2.90 (1.32)

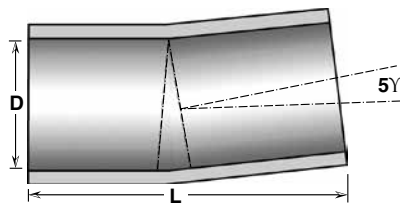

5° DOUBLE BELL COUPLING

Other angles can also be manufactured, such as 2.5° etc.

Please contact factory for additional information.

Nominal Size	Type	Item No.	D	L	Weight lbs kg
¾	XW	07C-XW-44	1.435 (36)	6 (152)	0.22 (0.10)
1	XW	10C-XW-44	1.700 (43)	6 (152)	0.29 (0.13)
1¼	XW	12C-XW-44	2.045 (52)	6 (152)	0.36 (0.16)
1½	XW	15C-XW-44	2.285 (58)	6 (152)	0.39 (0.18)
2	XW	20D-XW-44	2.520 (64)	10 (254)	0.92 (0.42)
2½	XW	25D-XW-44	3.025 (77)	10 (254)	1.28 (0.58)
3	XW	30D-XW-44	3.520 (89)	10 (254)	1.48 (0.67)
3½	XW	35D-XW-44	4.025 (102)	10 (254)	1.70 (0.77)
4	XW	40D-XW-44	4.520 (115)	10 (254)	1.53 (0.67)
5	XW	50D-XW-44	5.520 (140)	10 (254)	2.17 (0.98)
6	XW	60D-XW-44	6.520 (166)	10 (254)	2.55 (1.16)

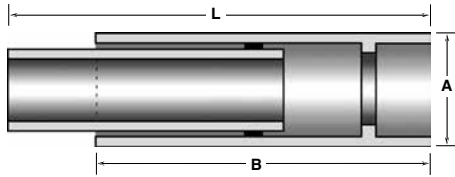

SINGLE EXPANSION JOINT SOCKET X SPIGOT WITH O-RING

Installation of Expansion Joints:

- When the duct is shorter than 50 ft., no Expansion Joint needed
- When the duct is between 50 ft. up to 200 ft., install one Expansion Joint at the mid point
- If the duct is longer than 200 ft., install one Expansion Joint every 200 ft. apart

Note: All Expansion Joints have a yellow line on the nipple end of the joint for proper installation.

Nominal Size	Type	Item No.	A	B	L - Min	L - Max	Weight	
							lbs	kg
¾	XW	07C-XW-36	1.935 (54)	12 (305)	15 (381)	23 (584)	1.40	(0.64)
1	XW	10C-XW-36	2.200 (61)	12 (305)	15 (381)	23 (584)	1.57	(0.71)
1¼	XW	12C-XW-36	2.545 (65)	12 (305)	15 (381)	23 (584)	1.89	(0.86)
1½	XW	15C-XW-36	2.785 (71)	12 (305)	15 (381)	23 (584)	2.72	(1.23)
2	XW	20D-XW-36	3.000 (76)	12 (305)	15 (381)	23 (584)	2.90	(1.32)
2½	XW	25D-XW-36	3.525 (90)	12 (305)	15 (381)	23 (584)	3.56	(1.61)
3	XW	30D-XW-36	4.000 (102)	12 (305)	15 (381)	23 (584)	4.19	(1.90)
3½	XW	35D-XW-36	4.525 (115)	12 (305)	15 (381)	23 (584)	4.83	(2.19)
4	XW	40D-XW-36	5.000 (127)	14 (356)	19 (482)	27 (686)	6.42	(2.92)
5	XW	50D-XW-36	6.000 (152)	14 (356)	19 (482)	27 (686)	7.94	(3.60)
6	XW	60D-XW-36	7.000 (178)	14 (356)	19 (482)	27 (686)	10.06	(4.57)

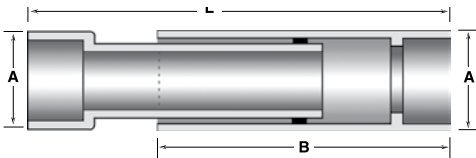

SINGLE EXPANSION JOINT SOCKET X SOCKET WITH O-RING

Installation of Expansion Joints:

- When the duct is shorter than 50 ft., no Expansion Joint needed
- When the duct is between 50 ft. up to 200 ft., install one Expansion Joint at the mid point
- If the duct is longer than 200 ft., install one Expansion Joint every 200 ft. apart

Note: All Expansion Joints have a yellow line on the nipple end of the joint for proper installation.

Nominal Size	Type	Item No.	A	B	L - Min	L - Max	Weight	
							lbs	kg
¾	XW	07C-XW-37	1.935 (54)	12 (305)	15 (381)	23 (584)	1.76	(0.80)
1	XW	10C-XW-37	2.200 (61)	12 (305)	15 (381)	23 (584)	1.97	(0.89)
1¼	XW	12C-XW-37	2.545 (65)	12 (305)	15 (381)	23 (584)	2.35	(1.07)
1½	XW	15C-XW-37	2.785 (71)	12 (305)	15 (381)	23 (584)	2.72	(1.23)
2	XW	20D-XW-37	3.000 (76)	12 (305)	18 (457)	26 (660)	3.62	(1.64)
2½	XW	25D-XW-37	3.525 (90)	12 (305)	18 (457)	26 (660)	4.44	(2.01)
3	XW	30D-XW-37	4.000 (102)	12 (305)	18 (457)	26 (660)	5.23	(2.37)
3½	XW	35D-XW-37	4.525 (115)	12 (305)	18 (457)	26 (660)	6.06	(2.75)
4	XW	40D-XW-37	5.000 (127)	14 (356)	22 (559)	32 (812)	7.89	(3.58)
5	XW	50D-XW-37	6.000 (152)	14 (356)	22 (559)	32 (812)	9.75	(4.43)
6	XW	60D-XW-37	7.000 (178)	14 (356)	22 (559)	32 (812)	12.08	(5.48)

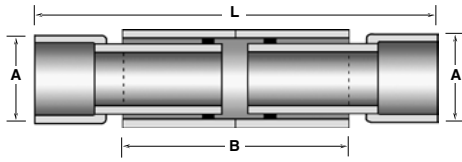

DOUBLE EXPANSION JOINT WITH O-RING

Double expansion joint is sometimes referred to as back-to-back expansion joint.

Installation of Expansion Joints:

- When the duct is shorter than 50 ft., no Expansion Joint needed
- When the duct is between 50 ft. up to 200 ft., install one Expansion Joint at the mid point
- If the duct is longer than 200 ft., install one Expansion Joint every 200 ft. apart

Note: All Expansion Joints have a yellow line on the nipple end of the joint for proper installation.

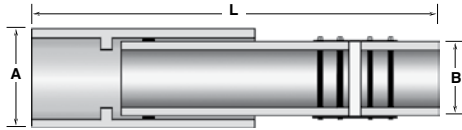

ALIGNMENT/EXPANSION FITTING, WITH O-RINGS

Alignment/Expansion fitting is sometimes referred to as an Expansion/Deflection joint.

(The clamps holding the rubber sleeve connecting the two nipples are made from stainless steel for ultimate corrosion protection).

Installation of Expansion Joints:

- When the duct is shorter than 50 ft., no Expansion Joint needed
- When the duct is between 50 ft. up to 200 ft., install one Expansion Joint at the mid point
- If the duct is longer than 200 ft., install one Expansion Joint every 200 ft. apart

Note: All Expansion Joints have a yellow line on the nipple end of the joint for proper installation.

Nominal Size	Type	Item No.	A	B	L - Min	L - Max	Weight lbs	kg
¾	XW	07C-XW-39	1.935 (54)	17 (432)	29 (737)	45 (1143)	3.01	(1.37)
1	XW	10C-XW-39	2.200 (61)	17 (432)	29 (737)	45 (1143)	3.36	(1.53)
1¼	XW	12C-XW-39	2.545 (65)	17 (432)	29 (737)	45 (1143)	4.06	(1.84)
1½	XW	15C-XW-39	2.785 (71)	17 (432)	29 (737)	45 (1143)	5.83	(2.65)
2	XW	20D-XW-39	3.000 (76)	17 (432)	29 (737)	45 (1143)	6.24	(2.83)
2½	XW	25D-XW-39	3.525 (90)	17 (432)	29 (737)	45 (1143)	7.63	(3.46)
3	XW	30D-XW-39	4.000 (102)	17 (432)	29 (737)	45 (1143)	9.01	(4.09)
3½	XW	35D-XW-39	4.525 (115)	17 (432)	29 (737)	45 (1143)	10.42	(4.72)
4	XW	40D-XW-39	5.000 (127)	17 (432)	29 (737)	45 (1143)	11.78	(5.35)
5	XW	50D-XW-39	6.000 (152)	17 (432)	29 (737)	45 (1143)	14.55	(6.61)
6	XW	60D-XW-39	7.000 (178)	17 (432)	29 (737)	45 (1143)	19.25	(8.74)

Nominal Size	Type	Item No.	A	B	L - Min	L - Max	Weight lbs	kg
¾	XW	07C-XW-31	1.935 (54)	1.410 (36)	37 (940)	51 (1295)	4.27	(1.94)
1	XW	10C-XW-31	2.200 (61)	1.675 (43)	37 (940)	51 (1295)	4.76	(2.16)
1¼	XW	12C-XW-31	2.545 (65)	2.020 (51)	37 (940)	51 (1295)	5.74	(2.60)
1½	XW	15C-XW-31	2.785 (71)	2.260 (57)	37 (940)	51 (1295)	8.26	(3.75)
2	XW	20D-XW-31	3.000 (76)	2.500 (64)	37 (940)	51 (1295)	8.82	(4.00)
2½	XW	25D-XW-31	3.525 (90)	3.000 (76)	37 (940)	51 (1295)	10.78	(4.89)
3	XW	30D-XW-31	4.000 (102)	3.500 (89)	37 (940)	51 (1295)	12.74	(5.78)
3½	XW	35D-XW-31	4.525 (115)	4.000 (102)	37 (940)	51 (1295)	14.70	(6.67)
4	XW	40D-XW-31	5.000 (127)	4.500 (114)	37 (940)	51 (1295)	16.66	(7.56)
5	XW	50D-XW-31	6.000 (152)	5.500 (140)	37 (940)	51 (1295)	20.58	(9.34)
6	XW	60D-XW-31	7.000 (178)	6.500 (165)	37 (940)	51 (1295)	24.50	(11.12)

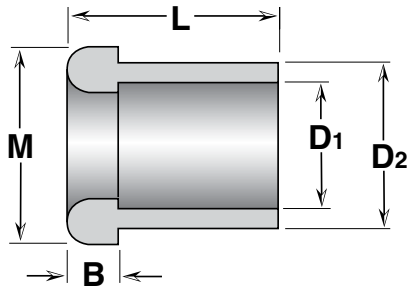

END BELLS-SOCKET TYPE

End bells are used for creating a permanent termination into a box as well as having a smooth surface that the cable can be pulled over.

Nominal Size	Type	Item No.	D1	D2	L	M	Weight	
							lbs	kg
¾	XW	07C-XW-29	1.432 (36)	1.935 (54)	1.60 (45)	2.48 (63)	0.63	(0.28)
1	XW	10C-XW-29	1.700 (43)	2.200 (61)	1.60 (45)	2.70 (68)	0.70	(0.32)
1¼	XW	12C-XW-29	2.045 (52)	2.545 (65)	1.60 (45)	3.11 (79)	0.85	(0.38)
1½	XW	15C-XW-29	2.285 (58)	2.785 (71)	1.60 (45)	3.35 (85)	1.22	(0.55)
2	XW	20D-XW-29	2.520 (64)	3.020 (76)	3.00 (76)	3.62 (92)	1.30	(0.59)
2½	XW	25D-XW-29	3.025 (77)	3.525 (90)	3.00 (76)	4.22 (107)	1.59	(0.72)
3	XW	30D-XW-29	3.520 (89)	4.020 (102)	3.00 (76)	4.62 (117)	1.90	(0.86)
3½	XW	35D-XW-29	4.025 (102)	4.525 (115)	3.00 (76)	5.48 (139)	2.17	(0.98)
4	XW	40D-XW-29	4.520 (115)	5.020 (128)	5.00 (127)	5.62 (143)	2.40	(1.09)
5	XW	50D-XW-29	5.520 (140)	6.020 (153)	5.00 (127)	6.62 (168)	2.42	(1.10)
6	XW	60D-XW-29	6.520 (166)	7.020 (178)	5.00 (127)	7.62 (194)	2.50	(1.13)

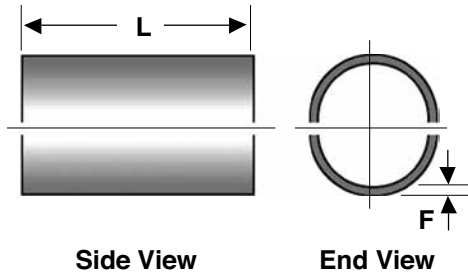

SPLIT ANCHOR RINGS

Nominal Size	Type	Item No.	F	L	Weight	
					lbs	kg
¾	XW	07C-XW-28	0.25 (6)	3 (76)	0.25	(0.11)
1	XW	10C-XW-28	0.25 (6)	3 (76)	0.28	(0.13)
1¼	XW	12C-XW-28	0.25 (6)	3 (76)	0.34	(0.15)
1½	XW	15C-XW-28	0.25 (6)	3 (76)	0.49	(0.22)
2	XW	20D-XW-28	0.25 (6)	3 (76)	0.52	(0.24)
2½	XW	25D-XW-28	0.25 (6)	3 (76)	0.64	(0.29)
3	XW	30D-XW-28	0.25 (6)	3 (76)	0.80	(0.36)
3½	XW	35D-XW-28	0.25 (6)	3 (76)	0.87	(0.39)
4	XW	40D-XW-28	0.25 (6)	3 (76)	0.98	(0.44)
5	XW	50D-XW-28	0.25 (6)	3 (76)	1.15	(0.52)
6	XW	60D-XW-28	0.25 (6)	3 (76)	1.25	(0.57)

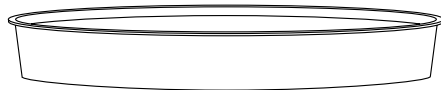

THERMOPLASTIC PLUG

Nominal Size	Type	Item No.	Weight	
			lbs	kg
¾	XW	07C-XW-26	0.01	(0.005)
1	XW	10C-XW-26	0.01	(0.005)
1¼	XW	12C-XW-26	0.01	(0.005)
1½	XW	15C-XW-26	0.01	(0.005)
2	XW	20D-XW-26	0.01	(0.005)
2½	XW	25D-XW-26	0.01	(0.005)
3	XW	30D-XW-26	0.03	(0.014)
3½	XW	35D-XW-26	0.03	(0.014)
4	XW	40D-XW-26	0.03	(0.014)
5	XW	50D-XW-26	0.06	(0.027)
6	XW	60D-XW-26	0.07	(0.032)

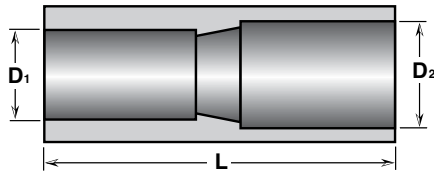

REDUCING ADAPTER

Nominal Size	Type	Reducing from and to	Item No.	D_1	D_2	L	Weight lbs	kg
1	XW	1 XW - ¾ XW	10C-XW-25-07C-XW	1.43 (36)	1.675 (42)	6 (152)	0.90	(0.41)
1¼	XW	1¼ XW - 1 XW	12C-XW-25-10C-XW	1.70 (43)	2.020 (51)	6 (152)	1.00	(0.45)
1¼	XW	1¼ XW - ¾ XW	12C-XW-25-07C-XW	1.43 (36)	2.020 (51)	6 (152)	1.10	(0.50)
1½	XW	1½ XW - 1½ XW	15C-XW-25-12C-XW	2.04 (52)	2.260 (57)	6 (152)	1.20	(0.54)
1½	XW	1½ XW - 1 XW	15C-XW-25-10C-XW	1.70 (43)	2.260 (57)	6 (152)	1.30	(0.59)
1½	XW	1½ XW - ¾ XW	15C-XW-25-07C-XW	1.43 (36)	2.260 (57)	6 (152)	1.35	(0.61)
2	XW	2 XW - 1½ XW	20D-XW-25-15C-XW	2.28 (58)	2.500 (64)	6 (152)	1.40	(0.64)
2½	XW	2½ XW - 2 XW	25D-XW-25-20D-XW	2.52 (54)	3.000 (76)	6 (152)	1.60	(0.73)
3	XW	3 XW - 2½ XW	30D-XW-25-25D-XW	3.02 (77)	3.500 (89)	6 (152)	1.70	(0.77)
3	XW	3 XW - 2 XW	30D-XW-25-20D-XW	2.52 (64)	3.500 (89)	6 (152)	1.80	(0.82)
3½	XW	3½ XW - 3 XW	35D-XW-25-30D-XW	3.52 (89)	4.000 (102)	6 (152)	2.00	(0.91)
4	XW	4 XW - 3½ XW	40D-XW-25-35D-XW	4.02 (102)	4.500 (114)	6 (152)	2.40	(1.09)
4	XW	4 XW - 3 XW	40D-XW-25-30D-XW	3.52 (89)	4.500 (114)	6 (152)	2.60	(1.18)

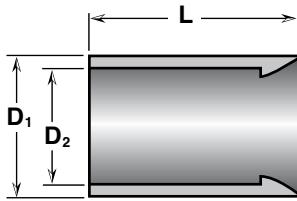

REDUCING BUSHING

Nominal Size	Type	Reducing from and to	Item No.	D_1	D_2	L	Weight lbs	kg
1	XW	1 XW - ¾ XW	10C-XW-49-07C-XW	1.675 (42)	1.43 (36)	3.000 (76)	0.5	(0.24)
1¼	XW	1¼ XW - 1 XW	12C-XW-49-10C-XW	2.020 (51)	1.70 (43)	3.325 (84)	0.6	(0.25)
1¼	XW	1¼ XW - ¾ XW	12C-XW-49-07C-XW	2.020 (51)	1.43 (36)	3.325 (84)	0.6	(0.25)
1½	XW	1½ XW - 1½ XW	15C-XW-49-12C-XW	2.260 (57)	2.04 (52)	3.325 (84)	0.7	(0.30)
1½	XW	1½ XW - 1 XW	15C-XW-49-10C-XW	2.260 (57)	1.70 (43)	3.325 (84)	0.7	(0.30)
1½	XW	1½ XW - ¾ XW	15C-XW-49-07C-XW	2.260 (57)	1.43 (36)	3.325 (84)	0.8	(0.34)
2	XW	2 XW - 1½ XW	20C-XW-49-15C-XW	2.500 (64)	2.28 (58)	4.000 (102)	0.9	(0.43)
2½	XW	2½ XW - 2 XW	25C-XW-49-20C-XW	3.000 (76)	2.52 (54)	4.000 (102)	1.1	(0.49)
3	XW	3 XW - 2½ XW	30C-XW-49-25C-XW	3.500 (89)	3.02 (77)	4.500 (114)	1.3	(0.58)
3	XW	3 XW - 2 XW	30C-XW-49-20C-XW	3.500 (89)	2.52 (64)	4.500 (114)	1.4	(0.62)
3½	XW	3½ XW - 3 XW	35C-XW-49-30C-XW	4.000 (102)	3.52 (89)	4.500 (114)	1.5	(0.68)
4	XW	4 XW - 3½ XW	40C-XW-49-35C-XW	4.500 (114)	4.02 (102)	4.500 (114)	1.8	(0.82)
4	XW	4 XW - 3 XW	40C-XW-49-30C-XW	4.500 (114)	3.52 (89)	4.500 (114)	2.0	(0.88)

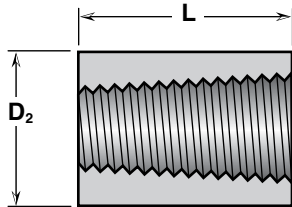

THREADED REDUCING BUSHING

Nominal Size	Type	Reducing from and to	Item No.	D_1	D_2	L	Weight lbs	kg
¾	XW	¾ XW - ½ Threaded	07C-XW-49-05C-32	--	--	1.41 (36)	2 (52)	0.30 (0.14)

OFFSET BEND

When manufacturing offset bends, the vertical offset dimension, H and the horizontal offset dimension, L, need to be specified.

All offset bends are supplied with 6" (152mm) straight ends. (Item numbers for offset bends end with the suffix - 47)

Contact your local sales representative or Champion Fiberglass directly for information.

