

Pipe and Conduit Hangers

CHAMPION STRUT™ CLEVIS HANGERS

Champion Strut clevis hangers are available in two types; injection molded glass-reinforced polyurethane and polyester or vinyl ester hand lay-up. The injection molded glass-reinforced clevis hangers are available for sizes 1/2" through 6". The hand lay-up clevis hangers are standardly provided in polyester fiberglass and available in sizes 1" through 24". Vinyl ester clevis hangers are available as a special-order item. Contact Champion Fiberglass for pricing and availability on vinyl ester clevis hangers.

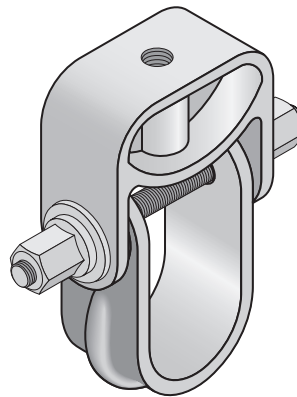

Molded

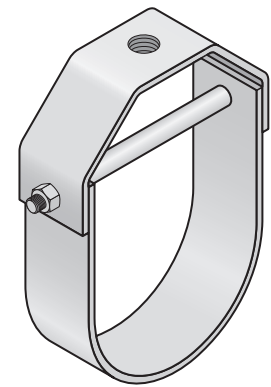

Hand Lay-up

CHAMPION STRUT™ MOLDED CLEVIS HANGERS

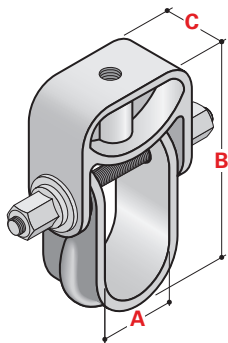

	ITEM NO	NOMINAL SIZE (IN)	MAX PIPE OD (IN)	DIMENSIONS			HANGER ROD SIZE (IN)	LOAD* (LBS)
				A (IN)	B (IN)	C (IN)		
<input type="checkbox"/>	CS-MCH-100	1/2" – 1"	1"	1.50"	4.25"	1.25"	1/2"	670
<input type="checkbox"/>	CS-MCH-150	1-1/4" – 1-1/2"	1-1/2"	2.00"	5.14"	1.25"	1/2"	670
<input type="checkbox"/>	CS-MCH-200	1-1/2" – 2"	2"	2.50"	6.52"	1.25"	1/2"	730
<input type="checkbox"/>	CS-MCH-400	2-1/2" – 4"	4"	5.13"	10.00"	1.50"	1/2"	1,150
<input type="checkbox"/>	CS-MCH-600	4-1/2" – 6"	6"	6.75"	12.33"	1.50"	1/2"	1,170

* Load values shown represent a 3:1 safety factor.



CHAMPION STRUT™ HAND LAY-UP CLEVIS HANGERS

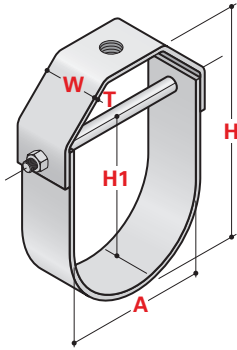

	ITEM NO	NOMINAL SIZE (IN)	T (IN)	H (IN)	H1 (IN)	W (IN)	HANGER ROD SIZE (IN)	TRANS ROD SIZE (IN)	SPREADER ROD SIZE (IN)	LOAD* (LBS)
<input type="checkbox"/>	CS-LCH-10	1" – 1-1/2"	1/8"	2.75"	1.875"	1.50"	1/2"	3/8"	1/2"	60
<input type="checkbox"/>	CS-LCH-15	1-1/2" – 2"	1/8"	3.50"	2.375"	1.50"	1/2"	3/8"	1/2"	60
<input type="checkbox"/>	CS-LCH-20	2" – 2-5/8"	1/8"	4.75"	3.00"	2.00"	1/2"	3/8"	1/2"	90
<input type="checkbox"/>	CS-LCH-25	2-1/2" – 3-1/4"	1/8"	5.50"	3.625"	2.00"	1/2"	3/8"	1/2"	120
<input type="checkbox"/>	CS-LCH-30	3" – 3-7/8"	1/8"	7.00"	4.250"	2.00"	5/8"	3/8"	1/2"	160
<input type="checkbox"/>	CS-LCH-40	4" – 5-1/8"	3/16"	8.50"	5.625"	2.00"	5/8"	3/8"	1/2"	250
<input type="checkbox"/>	CS-LCH-60	6" – 7-1/8"	3/16"	10.875"	7.50"	3.00"	5/8"	3/8"	1/2"	300
<input type="checkbox"/>	CS-LCH-80	8" – 9-1/4"	1/4"	14.00"	9.75"	3.00"	5/8"	3/8"	1/2"	350
<input type="checkbox"/>	CS-LCH-100	10" – 11-3/8"	1/4"	18.00"	12.00"	4.00"	5/8"	1/2"	3/4"	450
<input type="checkbox"/>	CS-LCH-120	12" – 13-1/2"	1/4"	21.50"	14.125"	5.00"	5/8"	1/2"	3/4"	600
<input type="checkbox"/>	CS-LCH-140	14" – 15-3/4"	1/4"	24.50"	16.50"	5.00"	3/4"	1/2"	3/4"	700
<input type="checkbox"/>	CS-LCH-160	16" – 18"	3/8"	27.375"	19.50"	6.00"	3/4"	3/4"	1"	750
<input type="checkbox"/>	CS-LCH-190	19" – 21"	3/8"	34.50"	22.50"	6.00"	3/4"	3/4"	1"	800
<input type="checkbox"/>	CS-LCH-210	21" – 22"	1/2"	35.50"	24.00"	6.00"	3/4"	3/4"	1"	850
<input type="checkbox"/>	CS-LCH-220	22" – 24"	1/2"	41.00"	28.00"	6.00"	3/4"	3/4"	1"	900

* Load values shown represent a 3:1 safety factor.

Pipe Hanging Accessories

CHAMPION STRUT™ BEAM MOLDED CLAMPS

The Champion Strut system has two types of molded beam clamps; light-duty and heavy-duty. The light-duty beam clamp has a 3/4" jaw opening and is available for both 3/8" and 1/2" threaded rod sizes and is not available with a "I" beam securing beam clip. The heavy-duty beam clamp has a 1" jaw opening and is available for 3/8", 1/2" and 5/8" threaded rod sizes. The heavy-duty beam clamp can be combined with the "I" beam securing beam clip for additional stability. Both the light-duty and heavy-duty beam clamps are provided with a 316 stainless steel hex head set screw.

CHAMPION LIGHT-DUTY MOLDED BEAM CLAMP

	ITEM NO	THREADED ROD SIZE (IN)	THREAD SHEAR (LBS)	TORQUE (FT/LBS)
<input type="checkbox"/>	CS-BC-375	3/8"	400	10
<input type="checkbox"/>	CS-BC-500	1/2"	400	10

* Load values shown represent a 3:1 safety factor

