

BOX CONNECTOR (Straight Threads)

A box connector creates a separable termination into a box. This connector has straight threads (NPS) and is supplied with a locknut. Sealing O-ring supplied by adding an EX suffix to the part number.

Nominal Size	Type	IPS Item No.		D	L	Weight	
		Belowground	Aboveground			lbs	kg
¾	SW	07A-SW-30	07C-SW-30	1.06 (27)	3 (76)	0.11	(.05)
1	SW	10A-SW-30	10C-SW-30	1.32 (34)	3 (76)	0.22	(.10)
1¼	SW	12A-SW-30	12C-SW-30	1.67 (42)	3 (76)	0.25	(.12)
1½	SW	15A-SW-30	15C-SW-30	1.91 (49)	3 (76)	0.29	(.13)
2	SW	20A-SW-30	20C-SW-30	2.40 (61)	5 (127)	0.85	(.39)
3	SW	30A-SW-30	30C-SW-30	3.52 (89)	5 (127)	1.28	(.58)
4	SW	40A-SW-30	40C-SW-30	4.47 (114)	5 (127)	2.09	(.95)
4	HW	40A-HW-30	40C-HW-30	4.52 (115)	5 (127)	2.09	(.95)
5	SW	50A-SW-30	50C-SW-30	5.54 (141)	5 (127)	2.75	(1.25)
5	MW	50A-MW-30	50C-MW-30	5.59 (142)	5 (127)	2.75	(1.25)
5	HW	50A-HW-30	50C-HW-30	5.63 (143)	5 (127)	2.75	(1.25)
6	SW	60A-SW-30	60C-SW-30	6.61 (168)	5 (127)	2.97	(1.35)
6	MW	60A-MW-30	60C-MW-30	6.66 (169)	5 (127)	2.97	(1.35)
6	HW	60A-HW-30	60C-HW-30	6.69 (170)	5 (127)	2.97	(1.35)

Nominal Size	Type	ID Item No.		D	L	Weight	
		Belowground	Aboveground			lbs	kg
2	SW	20B-SW-30	20D-SW-30	2.16 (55)	5 (127)	0.85	(.39)
2½	SW	25B-SW-30	25D-SW-30	2.66 (68)	5 (127)	0.94	(.43)
3	SW	30B-SW-30	30D-SW-30	3.16 (80)	5 (127)	1.28	(.58)
3½	SW	35B-SW-30	35D-SW-30	3.66 (93)	5 (127)	1.77	(.80)
4	SW	40B-SW-30	40D-SW-30	4.16 (106)	5 (127)	2.09	(.95)
4	HW	40B-HW-30	40D-HW-30	4.20 (107)	5 (127)	2.09	(.95)
4½	SW	45B-SW-30	45D-SW-30	4.66 (118)	5 (127)	2.40	(1.08)
4½	HW	45B-HW-30	45D-HW-30	4.70 (119)	5 (127)	2.40	(1.08)
5	SW	50B-SW-30	50D-SW-30	5.16 (131)	5 (127)	2.75	(1.25)
5	MW	50B-MW-30	50D-MW-30	5.20 (132)	5 (127)	2.75	(1.25)
5	HW	50B-HW-30	50D-HW-30	5.24 (133)	5 (127)	2.75	(1.25)
6	SW	60B-SW-30	60D-SW-30	6.16 (156)	5 (127)	2.97	(1.35)
6	MW	60B-MW-30	60D-MW-30	6.20 (157)	5 (127)	2.97	(1.35)
6	HW	60B-HW-30	60D-HW-30	6.24 (158)	5 (127)	2.97	(1.35)

Nominal Size	Type	Item No.		D	L	Weight	
		Belowground	Aboveground			lbs	kg
2	XW	20B-XW-30	20D-XW-30	2.520 (64)	5 (127)	0.85	(0.39)
2½	XW	25B-XW-30	25D-XW-30	3.025 (77)	5 (127)	0.94	(0.43)
3	XW	30B-XW-30	30D-XW-30	3.520 (89)	5 (127)	1.28	(0.58)
3½	XW	35B-XW-30	35D-XW-30	4.025 (102)	5 (127)	1.77	(0.80)
4	XW	40B-XW-30	40D-XW-30	4.520 (115)	7 (165)	2.09	(0.95)
5	XW	50B-XW-30	50D-XW-30	5.520 (140)	7 (165)	2.75	(1.25)
6	XW	60B-XW-30	60D-XW-30	6.520 (166)	7 (165)	2.97	(1.35)
8	XW	80A-XW-30	80C-XW-30	8.920 (227)	8 (203)	5.24	(2.37)

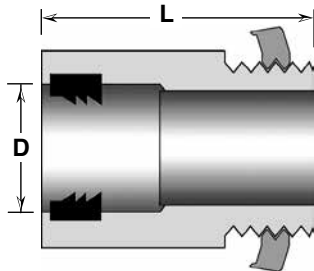

BOX CONNECTOR WITH GASKET (Straight Threads)

A box connector creates a separable termination into a box. This connector has straight threads (NPS) and is supplied with a locknut. Sealing O-ring supplied by adding an EX suffix to the part number.

Nominal Size	Type	IPS Item No.		D	L	Weight	
		Belowground	Aboveground			lbs	kg
¾	SW	07A-SW-30-G	07C-SW-30-G	1.06 (27)	3 (102)	0.08	(.04)
1	SW	10A-SW-30-G	10C-SW-30-G	1.32 (34)	3 (102)	0.08	(.04)
1¼	SW	12A-SW-30-G	12C-SW-30-G	1.67 (42)	3 (102)	0.15	(.07)
1½	SW	15A-SW-30-G	15C-SW-30-G	1.91 (49)	3 (102)	0.15	(.07)
2	SW	20A-SW-30-G	20C-SW-30-G	2.40 (61)	5 (127)	0.83	(0.38)
3	SW	30A-SW-30-G	30C-SW-30-G	3.52 (89)	5 (127)	1.10	(0.50)
4	SW	40A-SW-30-G	40C-SW-30-G	4.47 (114)	5 (127)	1.25	(0.57)
4	HW	40A-HW-30-G	40C-HW-30-G	4.52 (115)	5 (127)	1.25	(0.57)
5	SW	50A-SW-30-G	50C-SW-30-G	5.54 (141)	5 (127)	1.70	(0.77)
5	MW	50A-MW-30-G	50C-MW-30-G	5.59 (142)	5 (127)	1.65	(0.75)
5	HW	50A-HW-30-G	50C-HW-30-G	5.63 (143)	5 (127)	1.60	(0.73)
6	SW	60A-SW-30-G	60C-SW-30-G	6.61 (168)	5 (127)	2.20	(1.00)
6	MW	60A-MW-30-G	60C-MW-30-G	6.66 (169)	5 (127)	2.00	(0.91)
6	HW	60A-HW-30-G	60C-HW-30-G	6.69 (170)	5 (127)	1.80	(0.82)

Nominal Size	Type	ID Item No.		D	L	Weight	
		Belowground	Aboveground			lbs	kg
2	SW	20B-SW-30-G	20D-SW-30-G	2.16 (55)	5 (127)	0.65	(0.30)
2½	SW	25B-SW-30-G	25D-SW-30-G	2.66 (68)	5 (127)	0.80	(0.36)
3	SW	30B-SW-30-G	30D-SW-30-G	3.16 (80)	5 (127)	0.90	(0.41)
3½	SW	35B-SW-30-G	35D-SW-30-G	3.66 (93)	5 (127)	1.00	(0.45)
4	SW	40B-SW-30-G	40D-SW-30-G	4.16 (106)	5 (127)	1.40	(0.64)
4	HW	40B-HW-30-G	40D-HW-30-G	4.20 (107)	5 (127)	1.30	(0.59)
4½	SW	45B-SW-30-G	45D-SW-30-G	4.66 (118)	5 (127)	1.60	(0.73)
4½	HW	45B-HW-30-G	45D-HW-30-G	4.70 (119)	5 (127)	1.50	(0.68)
5	SW	50B-SW-30-G	50D-SW-30-G	5.16 (131)	5 (127)	1.60	(0.73)
5	MW	50B-MW-30-G	50D-MW-30-G	5.20 (132)	5 (127)	1.40	(0.64)
5	HW	50B-HW-30-G	50D-HW-30-G	5.24 (133)	5 (127)	1.28	(0.58)
6	SW	60B-SW-30-G	60D-SW-30-G	6.16 (156)	5 (127)	2.30	(1.04)
6	MW	60B-MW-30-G	60D-MW-30-G	6.20 (157)	5 (127)	2.10	(0.95)
6	HW	60B-HW-30-G	60D-HW-30-G	6.24 (158)	5 (127)	1.90	(0.86)

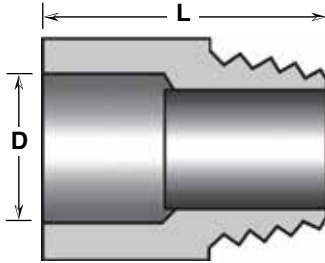

MALE ADAPTER (Tapered Threads)

Male adapters with tapered threads (NPT) are generally used for joining to female threads of rigid steel, Myers type hubs or terminating into precast iron boxes with female thread entrances.

Nominal Size	Type	IPS Item No.		D	L	Weight	
		Belowground	Aboveground			lbs	kg
¾	SW	07A-SW-33	07C-SW-33	1.06 (27)	3 (76)	0.08	(.04)
1	SW	10A-SW-33	10C-SW-33	1.32 (34)	3 (76)	0.08	(.04)
1¼	SW	12A-SW-33	12C-SW-33	1.67 (42)	3 (76)	0.15	(.07)
1½	SW	15A-SW-33	15C-SW-33	1.91 (49)	3 (76)	0.15	(.07)
2	SW	20A-SW-33	20C-SW-33	2.40 (61)	5 (127)	0.44	(.20)
3	SW	30A-SW-33	30C-SW-33	3.52 (89)	5 (127)	0.64	(.29)
4	SW	40A-SW-33	40C-SW-33	4.47 (114)	5 (127)	0.93	(.42)
4	HW	40A-HW-33	40C-HW-33	4.52 (115)	5 (127)	0.97	(.44)
5	SW	50A-SW-33	50C-SW-33	5.54 (141)	5 (127)	1.45	(.66)
5	MW	50A-MW-33	50C-MW-33	5.59 (142)	5 (127)	1.30	(.59)
5	HW	50A-HW-33	50C-HW-33	5.63 (143)	5 (127)	1.15	(.52)
6	SW	60A-SW-33	60C-SW-33	6.61 (168)	5 (127)	2.00	(.91)
6	MW	60A-MW-33	60C-MW-33	6.66 (169)	5 (127)	1.70	(.77)
6	HW	60A-HW-33	60C-HW-33	6.69 (170)	5 (127)	1.40	(.64)

Nominal Size	Type	ID Item No.		D	L	Weight	
		Belowground	Aboveground			lbs	kg
2	SW	20B-SW-33	20D-SW-33	2.16 (55)	5 (127)	0.43	(.20)
2½	SW	25B-SW-33	25D-SW-33	2.66 (68)	5 (127)	0.62	(.28)
3	SW	30B-SW-33	30D-SW-33	3.16 (80)	5 (127)	0.76	(.35)
3½	SW	35B-SW-33	35D-SW-33	3.66 (93)	5 (127)	0.86	(.39)
4	SW	40B-SW-33	40D-SW-33	4.16 (106)	5 (127)	1.02	(.46)
4	HW	40B-HW-33	40D-HW-33	4.20 (107)	5 (127)	0.95	(.43)
4½	SW	45B-SW-33	45D-SW-33	4.66 (118)	5 (127)	1.22	(.55)
4½	HW	45B-HW-33	45D-HW-33	4.70 (119)	5 (127)	1.15	(.52)
5	SW	50B-SW-33	50D-SW-33	5.16 (131)	5 (127)	1.53	(.70)
5	MW	50B-MW-33	50D-MW-33	5.20 (132)	5 (127)	1.30	(.59)
5	HW	50B-HW-33	50D-HW-33	5.24 (133)	5 (127)	1.18	(.54)
6	SW	60B-SW-33	60D-SW-33	6.16 (156)	5 (127)	2.08	(.94)
6	MW	60B-MW-33	60D-MW-33	6.20 (157)	5 (127)	1.40	(.64)
6	HW	60B-HW-33	60D-HW-33	6.24 (158)	5 (127)	1.30	(.59)

Nominal Size	Type	Item No.		D	L	Weight	
		Belowground	Aboveground			lbs	kg
2	XW	20B-XW-33	20D-XW-33	2.520 (64)	5 (127)	0.69	(0.31)
2½	XW	25B-XW-33	25D-XW-33	3.025 (77)	5 (127)	0.85	(0.38)
3	XW	30B-XW-33	30D-XW-33	3.520 (89)	5 (127)	1.00	(0.45)
3½	XW	35B-XW-33	35D-XW-33	4.025 (102)	5 (127)	1.28	(0.58)
4	XW	40B-XW-33	40D-XW-33	4.520 (115)	7 (178)	1.56	(0.71)
5	XW	50B-XW-33	50D-XW-33	5.520 (140)	7 (178)	2.08	(0.94)
6	XW	60B-XW-33	60D-XW-33	6.520 (166)	7 (178)	2.47	(1.12)

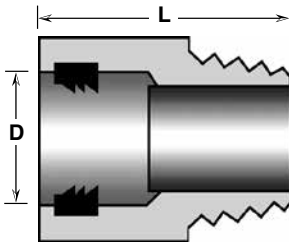

MALE ADAPTER WITH GASKET (Tapered Threads)

Male adapters with tapered threads (NPT) are generally used for joining to female threads of rigid steel, Myers type hubs or terminating into precast iron boxes with female thread entrances.

Nominal Size	Type	IPS Item No.		D	L	Weight	
		Belowground	Aboveground			lbs	kg
¾	SW	07A-SW-33-G	07C-SW-33-G	1.06 (27)	3 (102)	0.08	(0.04)
1	SW	10A-SW-33-G	10C-SW-33-G	1.32 (34)	3 (102)	0.08	(0.04)
1¼	SW	12A-SW-33-G	12C-SW-33-G	1.67 (42)	3 (102)	0.15	(0.07)
1½	SW	15A-SW-33-G	15C-SW-33-G	1.91 (49)	3 (102)	0.15	(0.07)
2	SW	20A-SW-33-G	20C-SW-33-G	2.40 (61)	5 (127)	0.83	(0.38)
3	SW	30A-SW-33-G	30C-SW-33-G	3.52 (89)	5 (127)	1.10	(0.50)
4	SW	40A-SW-33-G	40C-SW-33-G	4.47 (114)	5 (127)	1.35	(0.61)
4	HW	40A-HW-33-G	40C-HW-33-G	4.52 (115)	5 (127)	1.25	(0.57)
5	SW	50A-SW-33-G	50C-SW-33-G	5.54 (141)	5 (127)	1.70	(0.77)
5	MW	50A-MW-33-G	50C-MW-33-G	5.59 (142)	5 (127)	1.65	(0.75)
5	HW	50A-HW-33-G	50C-HW-33-G	5.63 (143)	5 (127)	1.68	(0.76)
6	SW	60A-SW-33-G	60C-SW-33-G	6.61 (168)	5 (127)	2.20	(1.00)
6	MW	60A-MW-33-G	60C-MW-33-G	6.66 (169)	5 (127)	2.00	(0.91)
6	HW	60A-HW-33-G	60C-HW-33-G	6.69 (170)	5 (127)	1.80	(0.82)

Nominal Size	Type	ID Item No.		D	L	Weight	
		Belowground	Aboveground			lbs	kg
2	SW	20B-SW-33-G	20D-SW-33-G	2.16 (55)	5 (127)	0.65	(0.30)
2½	SW	25B-SW-33-G	25D-SW-33-G	2.66 (68)	5 (127)	0.80	(0.36)
3	SW	30B-SW-33-G	30D-SW-33-G	3.16 (80)	5 (127)	0.90	(0.41)
3½	SW	35B-SW-33-G	35D-SW-33-G	3.66 (93)	5 (127)	1.00	(0.45)
4	SW	40B-SW-33-G	40D-SW-33-G	4.16 (106)	5 (127)	1.40	(0.64)
4	HW	40B-HW-33-G	40D-HW-33-G	4.20 (107)	5 (127)	1.30	(0.59)
4½	SW	45B-SW-33-G	45D-SW-33-G	4.66 (118)	5 (127)	1.60	(0.73)
4½	HW	45B-HW-33-G	45D-HW-33-G	4.70 (119)	5 (127)	1.50	(0.68)
5	SW	50B-SW-33-G	50D-SW-33-G	5.16 (131)	5 (127)	1.60	(0.73)
5	MW	50B-MW-33-G	50D-MW-33-G	5.20 (132)	5 (127)	1.40	(0.64)
5	HW	50B-HW-33-G	50D-HW-33-G	5.24 (133)	5 (127)	1.28	(0.58)
6	SW	60B-SW-33-G	60D-SW-33-G	6.16 (156)	5 (127)	2.30	(1.04)
6	MW	60B-MW-33-G	60D-MW-33-G	6.20 (157)	5 (127)	2.10	(0.95)
6	HW	60B-HW-33-G	60D-HW-33-G	6.24 (158)	5 (127)	1.90	(0.86)

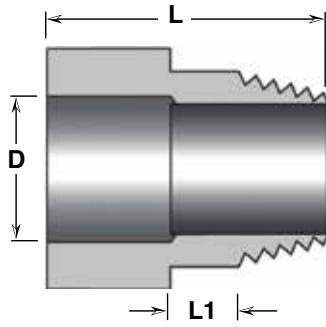

SPECIAL ADAPTER FOR PVC COATED FITTINGS
(Male Terminal Adapter)

This terminal adapter has tapered threads and a straight shoulder so it can fit under the PVC sleeve of a PVC coated steel fitting.

Nominal Size	Type	IPS Item No.		D	L	L1	Weight	
		Belowground	Aboveground				lbs	kg
3/4	SW	07A-SW-24	07C-SW-24	1.06 (27)	3 3/4 (95)	3/4	0.10	(3.00)
1	SW	10A-SW-24	10C-SW-24	1.32 (34)	4 (102)	1	0.13	(3.00)
1 1/4	SW	12A-SW-24	12C-SW-24	1.67 (42)	4 1/4 (108)	1 1/4	0.18	(5.00)
1 1/2	SW	15A-SW-24	15C-SW-24	1.91 (49)	4 1/2 (114)	1 1/2	0.18	(5.00)
2	SW	20A-SW-24	20C-SW-24	2.40 (61)	7 (178)	2	0.60	(15.00)
3	SW	30A-SW-24	30C-SW-24	3.52 (89)	7 (178)	2	0.80	(20.00)
4	SW	40A-SW-24	40C-SW-24	4.47 (114)	7 (178)	2	1.20	(30.00)
4	HW	40A-HW-24	40C-HW-24	4.52 (115)	7 (178)	2	1.30	(33.00)
5	SW	50A-SW-24	50C-SW-24	5.54 (141)	7 (178)	2	1.90	(48.00)
5	MW	50A-MW-24	50C-MW-24	5.59 (142)	7 (178)	2	1.70	(43.00)
5	HW	50A-HW-24	50C-HW-24	5.63 (143)	7 (178)	2	1.50	(38.00)
6	SW	60A-SW-24	60C-SW-24	6.61 (168)	7 (178)	2	2.60	(66.00)
6	MW	60A-MW-24	60C-MW-24	6.66 (169)	7 (178)	2	2.20	(56.00)
6	HW	60A-HW-24	60C-HW-24	6.69 (170)	7 (178)	2	1.80	(46.00)

Nominal Size	Type	Item No.		D	L	L1	Weight	
		Belowground	Aboveground				lbs	kg
2	XW	20B-XW-24	20D-XW-24	2.520 (64)	7 (178)	2 (51)	0.69	(0.31)
2 1/2	XW	25B-XW-24	25D-XW-24	3.025 (77)	7 (178)	2 (51)	1.20	(0.45)
3	XW	30B-XW-24	30D-XW-24	3.520 (89)	7 (178)	2 (51)	1.00	(0.45)
3 1/2	XW	35B-XW-24	35D-XW-24	4.025 (102)	7 (178)	2 (51)	1.20	(0.54)
4	XW	40B-XW-24	40D-XW-24	4.520 (115)	7 (178)	2 (51)	1.56	(0.71)
5	XW	50B-XW-24	50D-XW-24	5.520 (140)	7 (178)	2 (51)	2.08	(0.94)
6	XW	60B-XW-24	60D-XW-24	6.520 (166)	7 (178)	2 (51)	2.47	(1.12)

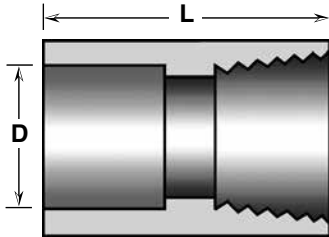

FEMALE TERMINAL ADAPTER

This adapter is generally used for joining fiberglass conduit with galvanized rigid steel (GRS) conduit. It has the same threads as GRS conduit and can easily be attached to GRS conduit.

Nominal Size	Type	IPS Item No.		D	L	Weight	
		Belowground	Aboveground			lbs	kg
3/4	SW	07A-SW-32	07C-SW-32	1.06 (27)	3.0 (76)	0.07	(0.03)
1	SW	10A-SW-32	10C-SW-32	1.32 (34)	3.0 (76)	0.13	(0.06)
1 1/4	SW	12A-SW-32	12C-SW-32	1.67 (42)	3.0 (76)	0.18	(0.08)
1 1/2	SW	15A-SW-32	15C-SW-32	1.91 (49)	3.0 (76)	0.21	(0.10)
2	SW	20A-SW-32	20C-SW-32	2.40 (61)	5.0 (127)	0.47	(0.21)
3	SW	30A-SW-32	30C-SW-32	3.52 (89)	5.0 (127)	0.80	(0.36)
4	SW	40A-SW-32	40C-SW-32	4.47 (114)	5.0 (127)	1.05	(0.48)
4	HW	40A-HW-32	40C-HW-32	4.52 (115)	5.0 (127)	1.00	(0.45)
5	SW	50A-SW-32	50C-SW-32	5.54 (141)	5.0 (127)	1.10	(0.50)
5	MW	50A-MW-32	50C-MW-32	5.59 (142)	5.0 (127)	1.05	(0.48)
5	HW	50A-HW-32	50C-HW-32	5.63 (143)	5.0 (127)	1.00	(0.45)
6	SW	60A-SW-32	60C-SW-32	6.61 (168)	5.0 (127)	1.15	(0.52)
6	MW	60A-MW-32	60C-MW-32	6.66 (169)	5.0 (127)	1.10	(0.50)
6	HW	60A-HW-32	60C-HW-32	6.69 (170)	5.0 (127)	1.05	(0.48)

Nominal Size	Type	ID Item No.		D	L	Weight	
		Belowground	Aboveground			lbs	kg
2	SW	20B-SW-32	20D-SW-32	2.16 (55)	5 (127)	0.75	(0.34)
2 1/2	SW	25B-SW-32	25D-SW-32	2.66 (55)	5 (127)	1.00	(0.45)
3	SW	30B-SW-32	30D-SW-32	3.16 (80)	5 (127)	1.08	(0.49)
3 1/2	SW	35B-SW-32	35D-SW-32	3.66 (93)	5 (127)	1.18	(0.54)
4	SW	40B-SW-32	40D-SW-32	4.16 (106)	5 (127)	1.25	(0.57)
4	HW	40B-HW-32	40D-HW-32	4.20 (107)	5 (127)	1.08	(0.49)
4 1/2	SW	45B-SW-32	45D-SW-32	4.66 (118)	5 (127)	1.50	(0.68)
4 1/2	HW	45B-HW-32	45D-HW-32	4.70 (119)	5 (127)	1.40	(0.64)
5	SW	50B-SW-32	50D-SW-32	5.16 (131)	5 (127)	1.90	(0.86)
5	MW	50B-MW-32	50D-MW-32	5.20 (132)	5 (127)	1.75	(0.80)
5	HW	50B-HW-32	50D-HW-32	5.24 (133)	5 (127)	1.65	(0.75)
6	SW	60B-SW-32	60D-SW-32	6.16 (156)	5 (127)	2.13	(0.97)
6	MW	60B-MW-32	60D-MW-32	6.20 (157)	5 (127)	2.00	(0.91)
6	HW	60B-HW-32	60D-HW-32	6.24 (158)	5 (127)	1.83	(0.83)

Nominal Size	Type	Item No.		D	L	Weight	
		Belowground	Aboveground			lbs	kg
2	XW	20B-XW-32	20D-XW-32	2.520 (64)	5 (127)	1.20	(0.55)
2 1/2	XW	25B-XW-32	25D-XW-32	3.025 (77)	5 (127)	0.85	(0.38)
3	XW	30B-XW-32	30D-XW-32	3.520 (89)	5 (127)	1.40	(0.64)
3 1/2	XW	35B-XW-32	35D-XW-32	4.025 (102)	5 (127)	1.28	(0.58)
4	XW	40B-XW-32	40D-XW-32	4.520 (115)	7 (178)	2.08	(0.94)
5	XW	50B-XW-32	50D-XW-32	5.520 (140)	7 (178)	2.60	(1.18)
6	XW	60B-XW-32	60D-XW-32	6.520 (166)	7 (178)	3.51	(1.59)

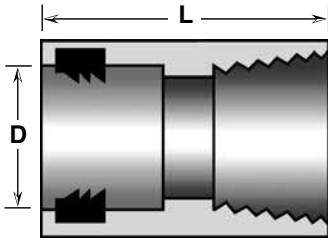

FEMALE TERMINAL ADAPTER W/GASKET

This adapter is generally used for joining fiberglass conduit with galvanized rigid steel (GRS) conduit. It has the same threads as GRS conduit and can easily be attached to GRS conduit.

Nominal Size	Type	IPS Item No.		D	L	Weight	
		Belowground	Aboveground			lbs	kg
3/4	SW	07A-SW-32-G	07C-SW-32-G	1.06 (27)	3 (102)	0.07	(0.03)
1	SW	10A-SW-32-G	10C-SW-32-G	1.32 (34)	3 (102)	0.13	(0.06)
1 1/4	SW	12A-SW-32-G	12C-SW-32-G	1.67 (42)	3 (102)	0.18	(0.08)
1 1/2	SW	15A-SW-32-G	15C-SW-32-G	1.91 (49)	3 (102)	0.21	(0.10)
2	SW	20A-SW-32-G	20C-SW-32-G	2.40 (61)	5 (127)	0.47	(0.21)
3	SW	30A-SW-32-G	30C-SW-32-G	3.52 (89)	5 (127)	0.80	(0.36)
4	SW	40A-SW-32-G	40C-SW-32-G	4.47 (114)	5 (127)	1.05	(0.48)
4	HW	40A-HW-32-G	40C-HW-32-G	4.52 (115)	5 (127)	1.00	(0.45)
5	SW	50A-SW-32-G	50C-SW-32-G	5.54 (141)	5 (127)	1.10	(0.50)
5	MW	50A-MW-32-G	50C-MW-32-G	5.59 (142)	5 (127)	1.05	(0.48)
5	HW	50A-HW-32-G	50C-HW-32-G	5.63 (143)	5 (127)	1.00	(0.45)
6	SW	60A-SW-32-G	60C-SW-32-G	6.61 (168)	5 (127)	1.15	(0.52)
6	MW	60A-MW-32-G	60C-MW-32-G	6.66 (169)	5 (127)	1.10	(0.50)
6	HW	60A-HW-32-G	60C-HW-32-G	6.69 (170)	5 (127)	1.05	(0.48)

Nominal Size	Type	ID Item No.		D	L	Weight	
		Belowground	Aboveground			lbs	kg
2	SW	20B-SW-32-G	20D-SW-32-G	2.16 (55)	5 (127)	0.75	(0.34)
2 1/2	SW	25B-SW-32-G	25D-SW-32-G	2.66 (68)	5 (127)	1.00	(0.45)
3	SW	30B-SW-32-G	30D-SW-32-G	3.16 (80)	5 (127)	1.08	(0.49)
3 1/2	SW	35B-SW-32-G	35D-SW-32-G	3.66 (93)	5 (127)	1.18	(0.54)
4	SW	40B-SW-32-G	40D-SW-32-G	4.16 (106)	5 (127)	1.25	(0.57)
4	HW	40B-HW-32-G	40D-HW-32-G	4.20 (107)	5 (127)	1.08	(0.49)
4 1/2	SW	45B-SW-32-G	45D-SW-32-G	4.66 (118)	5 (127)	1.50	(0.68)
4 1/2	HW	45B-HW-32-G	45D-HW-32-G	4.70 (119)	5 (127)	1.40	(0.64)
5	SW	50B-SW-32-G	50D-SW-32-G	5.16 (131)	5 (127)	1.90	(0.86)
5	MW	50B-MW-32-G	50D-MW-32-G	5.20 (132)	5 (127)	1.75	(0.80)
5	HW	50B-HW-32-G	50D-HW-32-G	5.24 (133)	5 (127)	1.65	(0.75)
6	SW	60B-SW-32-G	60D-SW-32-G	6.16 (156)	5 (127)	2.13	(0.97)
6	MW	60B-MW-32-G	60D-MW-32-G	6.20 (157)	5 (127)	2.00	(0.91)
6	HW	60B-HW-32-G	60D-HW-32-G	6.24 (158)	5 (127)	1.83	(0.83)

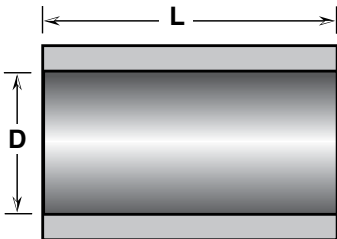

SLEEVE COUPLING

Nominal Size	Type	IPS Item No.		D	L	Weight	
		Belowground	Aboveground			lbs	kg
3/4	SW	07A-SW-42	07C-SW-42	1.06 (27)	6 (152)	0.06	(0.03)
1	SW	10A-SW-42	10C-SW-42	1.32 (34)	6 (152)	0.08	(0.04)
1 1/4	SW	12A-SW-42	12C-SW-42	1.67 (42)	6 (152)	0.10	(0.05)
1 1/2	SW	15A-SW-42	15C-SW-42	1.91 (49)	6 (152)	0.11	(0.05)
2	SW	20A-SW-42	20C-SW-42	2.40 (61)	6 (152)	0.20	(0.09)
3	SW	30A-SW-42	30C-SW-42	3.52 (89)	6 (152)	0.30	(0.14)
4	SW	40A-SW-42	40C-SW-42	4.47 (114)	6 (152)	0.36	(0.16)
4	HW	40A-HW-42	40C-HW-42	4.52 (115)	6 (152)	0.50	(0.23)
5	SW	50A-SW-42	50C-SW-42	5.54 (141)	6 (152)	0.45	(0.20)
5	MW	50A-MW-42	50C-MW-42	5.59 (142)	6 (152)	0.60	(0.27)
5	HW	50A-HW-42	50C-HW-42	5.63 (143)	6 (152)	0.70	(0.32)
6	SW	60A-SW-42	60C-SW-42	6.61 (168)	6 (152)	0.50	(0.23)
6	MW	60A-MW-42	60C-MW-42	6.66 (169)	6 (152)	0.80	(0.36)
6	HW	60A-HW-42	60C-HW-42	6.69 (170)	6 (152)	0.90	(0.41)

Nominal Size	Type	ID Item No.		D	L	Weight	
		Belowground	Aboveground			lbs	kg
2	SW	20B-SW-42	20D-SW-42	2.16 (55)	6 (152)	0.17	(0.08)
2 1/2	SW	25B-SW-42	25D-SW-42	2.66 (68)	6 (152)	0.21	(0.10)
3	SW	30B-SW-42	30D-SW-42	3.16 (80)	6 (152)	0.24	(0.11)
3 1/2	SW	35B-SW-42	35D-SW-42	3.66 (93)	6 (152)	0.32	(0.15)
4	SW	40B-SW-42	40D-SW-42	4.16 (106)	6 (152)	0.35	(0.16)
4	HW	40B-HW-42	40D-HW-42	4.20 (107)	6 (152)	0.46	(0.21)
4 1/2	SW	45B-SW-42	45D-SW-42	4.66 (118)	6 (152)	0.38	(0.17)
4 1/2	HW	45B-HW-42	45D-HW-42	4.70 (119)	6 (152)	0.54	(0.25)
5	SW	50B-SW-42	50D-SW-42	5.16 (131)	6 (152)	0.43	(0.20)
5	MW	50B-MW-42	50D-MW-42	5.20 (132)	6 (152)	0.60	(0.27)
5	HW	50B-HW-42	50D-HW-42	5.24 (133)	6 (152)	0.70	(0.32)
6	SW	60B-SW-42	60D-SW-42	6.16 (156)	6 (152)	0.48	(0.22)
6	MW	60B-MW-42	60D-MW-42	6.20 (157)	6 (152)	0.83	(0.38)
6	HW	60B-HW-42	60D-HW-42	6.24 (158)	6 (152)	1.15	(0.52)

Nominal Size	Type	Item No.		D	L	Weight	
		Belowground	Aboveground			lbs	kg
2	XW	20B-XW-42	20D-XW-42	2.520 (64)	6 (152)	0.53	(0.24)
2 1/2	XW	25B-XW-42	25D-XW-42	3.025 (77)	6 (152)	0.77	(0.35)
3	XW	30B-XW-42	30D-XW-42	3.520 (89)	6 (152)	0.75	(0.34)
3 1/2	XW	35B-XW-42	35D-XW-42	4.025 (102)	6 (152)	1.12	(0.51)
4	XW	40B-XW-42	40D-XW-42	4.520 (115)	10 (254)	1.50	(0.68)
5	XW	50B-XW-42	50D-XW-42	5.520 (140)	10 (254)	2.08	(0.94)
6	XW	60B-XW-42	60D-XW-42	6.520 (166)	10 (254)	2.50	(1.13)

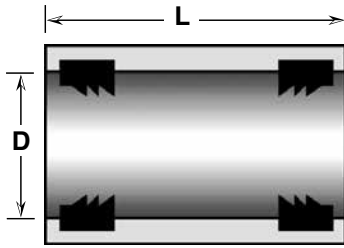

SLEEVE COUPLING WITH GASKET

Nominal Size	Type	IPS Item No.		D	L	Weight	
		Belowground	Aboveground			lbs	kg
¾	SW	07A-SW-42-G	07C-SW-42-G	1.06 (27)	8 (203)	0.06	(0.03)
1	SW	10A-SW-42-G	10C-SW-42-G	1.32 (34)	8 (203)	0.08	(0.04)
1¼	SW	12A-SW-42-G	12C-SW-42-G	1.67 (42)	8 (203)	0.10	(0.05)
1½	SW	15A-SW-42-G	15C-SW-42-G	1.91 (49)	8 (203)	0.11	(0.05)
2	SW	20A-SW-42-G	20C-SW-42-G	2.40 (61)	8 (203)	0.70	(0.32)
3	SW	30A-SW-42-G	30C-SW-42-G	3.52 (89)	8 (203)	0.95	(0.43)
4	SW	40A-SW-42-G	40C-SW-42-G	4.47 (114)	8 (203)	1.30	(0.59)
4	HW	40A-HW-42-G	40C-HW-42-G	4.52 (115)	8 (203)	1.40	(0.64)
5	SW	50A-SW-42-G	50C-SW-42-G	5.54 (141)	8 (203)	1.60	(0.73)
5	MW	50A-MW-42-G	50C-MW-42-G	5.59 (142)	8 (203)	1.80	(0.82)
5	HW	50A-HW-42-G	50C-HW-42-G	5.63 (143)	8 (203)	1.90	(0.86)
6	SW	60A-SW-42-G	60C-SW-42-G	6.61 (168)	8 (203)	2.00	(0.91)
6	MW	60A-MW-42-G	60C-MW-42-G	6.66 (169)	8 (203)	2.10	(0.95)
6	HW	60A-HW-42-G	60C-HW-42-G	6.69 (170)	8 (203)	2.40	(1.09)

Nominal Size	Type	ID Item No.		D	L	Weight	
		Belowground	Aboveground			lbs	kg
2	SW	20B-SW-42-G	20D-SW-42-G	2.16 (55)	8 (203)	0.70	(0.32)
2½	SW	25B-SW-42-G	25D-SW-42-G	2.66 (68)	8 (203)	0.80	(0.36)
3	SW	30B-SW-42-G	30D-SW-42-G	3.16 (80)	8 (203)	0.95	(0.43)
3½	SW	35B-SW-42-G	35D-SW-42-G	3.66 (93)	8 (203)	1.20	(0.55)
4	SW	40B-SW-42-G	40D-SW-42-G	4.16 (106)	8 (203)	1.30	(0.59)
4	HW	40B-HW-42-G	40D-HW-42-G	4.20 (107)	8 (203)	1.40	(0.64)
4½	SW	45B-SW-42-G	45D-SW-42-G	4.66 (118)	8 (203)	1.50	(0.68)
4½	HW	45B-HW-42-G	45D-HW-42-G	4.70 (119)	8 (203)	1.60	(0.73)
5	SW	50B-SW-42-G	50D-SW-42-G	5.16 (131)	8 (203)	1.60	(0.73)
5	MW	50B-MW-42-G	50D-MW-42-G	5.20 (132)	8 (203)	1.70	(0.77)
5	HW	50B-HW-42-G	50D-HW-42-G	5.24 (133)	8 (203)	1.80	(0.82)
6	SW	60B-SW-42-G	60D-SW-42-G	6.16 (156)	8 (203)	1.90	(0.86)
6	MW	60B-MW-42-G	60D-MW-42-G	6.20 (157)	8 (203)	1.90	(0.86)
6	HW	60B-HW-42-G	60D-HW-42-G	6.24 (158)	8 (203)	2.00	(0.91)

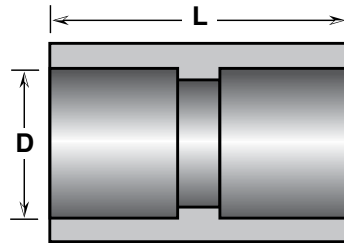

STOP COUPLING

Stop coupling is sometimes referred to as a double bell coupling.

Nominal Size	Type	IPS Item No.		D	L	Weight	
		Belowground	Aboveground			lbs	kg
¾	SW	07A-SW-40	07C-SW-40	1.06 (27)	6 (152)	0.07	(0.03)
1	SW	10A-SW-40	10C-SW-40	1.32 (34)	6 (152)	0.08	(0.04)
1¼	SW	12A-SW-40	12C-SW-40	1.67 (42)	6 (152)	0.09	(0.04)
1½	SW	15A-SW-40	15C-SW-40	1.91 (49)	6 (152)	0.11	(0.05)
2	SW	20A-SW-40	20C-SW-40	2.40 (61)	6 (152)	0.20	(0.10)
3	SW	30A-SW-40	30C-SW-40	3.52 (89)	6 (152)	0.30	(0.14)
4	SW	40A-SW-40	40C-SW-40	4.47 (114)	6 (152)	0.43	(0.20)
4	HW	40A-HW-40	40C-HW-40	4.52 (115)	6 (152)	0.58	(0.26)
5	SW	50A-SW-40	50C-SW-40	5.54 (141)	6 (152)	0.50	(0.23)
5	MW	50A-MW-40	50C-MW-40	5.59 (142)	6 (152)	0.70	(0.31)
5	HW	50A-HW-40	50C-HW-40	5.63 (143)	6 (152)	0.90	(0.41)
6	SW	60A-SW-40	60C-SW-40	6.61 (168)	6 (152)	0.65	(0.30)
6	MW	60A-MW-40	60C-MW-40	6.66 (169)	6 (152)	0.85	(0.39)
6	HW	60A-HW-40	60C-HW-40	6.69 (170)	6 (152)	0.95	(0.43)

Nominal Size	Type	ID Item No.		D	L	Weight	
		Belowground	Aboveground			lbs	kg
2	SW	20B-SW-40	20D-SW-40	2.16 (55)	6 (152)	0.20	(0.09)
2½	SW	25B-SW-40	25D-SW-40	2.66 (68)	6 (152)	0.25	(0.11)
3	SW	30B-SW-40	30D-SW-40	3.16 (80)	6 (152)	0.30	(0.14)
3½	SW	35B-SW-40	35D-SW-40	3.66 (93)	6 (152)	0.35	(0.16)
4	SW	40B-SW-40	40D-SW-40	4.16 (106)	6 (152)	0.40	(0.18)
4	HW	40B-HW-40	40D-HW-40	4.20 (107)	6 (152)	0.54	(0.25)
4½	SW	45B-SW-40	45D-SW-40	4.66 (118)	6 (152)	0.45	(0.20)
4½	HW	45B-HW-40	45D-HW-40	4.70 (119)	6 (152)	0.60	(0.27)
5	SW	50B-SW-40	50D-SW-40	5.16 (131)	6 (152)	0.50	(0.23)
5	MW	50B-MW-40	50D-MW-40	5.20 (132)	6 (152)	0.68	(0.31)
5	HW	50B-HW-40	50D-HW-40	5.24 (133)	6 (152)	0.80	(0.36)
6	SW	60B-SW-40	60D-SW-40	6.16 (156)	6 (152)	0.60	(0.27)
6	MW	60B-MW-40	60D-MW-40	6.20 (157)	6 (152)	0.80	(0.36)
6	HW	60B-HW-40	60D-HW-40	6.24 (158)	6 (152)	0.92	(0.42)

Nominal Size	Type	Item No.		D	L	Weight	
		Belowground	Aboveground			lbs	kg
2	XW	20B-XW-40	20D-XW-40	2.520 (64)	6 (152)	0.65	(0.29)
2½	XW	25B-XW-40	25D-XW-40	3.025 (77)	6 (152)	0.77	(0.35)
3	XW	30B-XW-40	30D-XW-40	3.520 (89)	6 (152)	0.95	(0.43)
3½	XW	35B-XW-40	35D-XW-40	4.025 (102)	6 (152)	1.12	(0.51)
4	XW	40B-XW-40	40D-XW-40	4.520 (115)	10 (254)	2.00	(0.91)
5	XW	50B-XW-40	50D-XW-40	5.520 (140)	10 (254)	2.50	(1.13)
6	XW	60B-XW-40	60D-XW-40	6.520 (166)	10 (254)	2.90	(1.32)

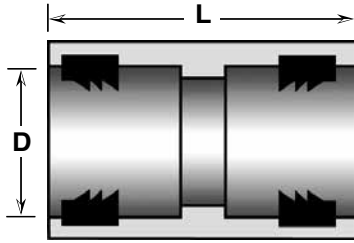

STOP COUPLING WITH GASKET

Stop coupling is sometimes referred to as a double bell coupling.

Nominal Size	Type	IPS Item No.		D	L	Weight	
		Belowground	Aboveground			lbs	kg
¾	SW	07A-SW-40-G	07C-SW-40-G	1.06 (27)	8 (203)	0.07	(0.03)
1	SW	10A-SW-40-G	10C-SW-40-G	1.32 (34)	8 (203)	0.08	(0.04)
1¼	SW	12A-SW-40-G	12C-SW-40-G	1.67 (42)	8 (203)	0.09	(0.04)
1½	SW	15A-SW-40-G	15C-SW-40-G	1.91 (49)	8 (203)	0.11	(0.05)
2	SW	20A-SW-40-G	20C-SW-40-G	2.40 (61)	8 (203)	0.70	(0.32)
3	SW	30A-SW-40-G	30C-SW-40-G	3.52 (89)	8 (203)	0.95	(0.43)
4	SW	40A-SW-40-G	40C-SW-40-G	4.47 (114)	8 (203)	1.30	(0.59)
4	HW	40A-HW-40-G	40C-HW-40-G	4.52 (115)	8 (203)	1.40	(0.64)
5	SW	50A-SW-40-G	50C-SW-40-G	5.54 (141)	8 (203)	1.60	(0.73)
5	MW	50A-MW-40-G	50C-MW-40-G	5.59 (142)	8 (203)	1.80	(0.82)
5	HW	50A-HW-40-G	50C-HW-40-G	5.63 (143)	8 (203)	1.90	(0.86)
6	SW	60A-SW-40-G	60C-SW-40-G	6.61 (168)	8 (203)	2.00	(0.91)
6	MW	60A-MW-40-G	60C-MW-40-G	6.66 (169)	8 (203)	2.10	(0.95)
6	HW	60A-HW-40-G	60C-HW-40-G	6.69 (170)	8 (203)	2.40	(1.09)

Nominal Size	Type	ID Item No.		D	L	Weight	
		Belowground	Aboveground			lbs	kg
2	SW	20B-SW-40-G	20D-SW-40-G	2.16 (55)	8 (203)	0.70	(0.32)
2½	SW	25B-SW-40-G	25D-SW-40-G	2.66 (68)	8 (203)	0.80	(0.36)
3	SW	30B-SW-40-G	30D-SW-40-G	3.16 (80)	8 (203)	0.95	(0.43)
3½	SW	35B-SW-40-G	35D-SW-40-G	3.66 (93)	8 (203)	1.20	(0.55)
4	SW	40B-SW-40-G	40D-SW-40-G	4.16 (106)	8 (203)	1.30	(0.59)
4	HW	40B-HW-40-G	40D-HW-40-G	4.20 (107)	8 (203)	1.40	(0.64)
4½	SW	45B-SW-40-G	45D-SW-40-G	4.66 (118)	8 (203)	1.50	(0.68)
4½	HW	45B-HW-40-G	45D-HW-40-G	4.70 (119)	8 (203)	1.60	(0.73)
5	SW	50B-SW-40-G	50D-SW-40-G	5.16 (131)	8 (203)	1.60	(0.73)
5	MW	50B-MW-40-G	50D-MW-40-G	5.20 (132)	8 (203)	1.70	(0.77)
5	HW	50B-HW-40-G	50D-HW-40-G	5.24 (133)	8 (203)	1.80	(0.82)
6	SW	60B-SW-40-G	60D-SW-40-G	6.16 (156)	8 (203)	1.90	(0.86)
6	MW	60B-MW-40-G	60D-MW-40-G	6.20 (157)	8 (203)	1.90	(0.86)
6	HW	60B-HW-40-G	60D-HW-40-G	6.24 (158)	8 (203)	2.00	(0.91)

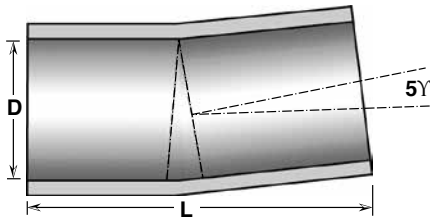

5° DOUBLE BELL COUPLING

Other angles can also be manufactured, such as 2.5° etc. Please contact factory for consultation.

Nominal Size	Type	IPS Item No.		D	L	Weight	
		Belowground	Aboveground			lbs	kg
¾	SW	07A-SW-44	07C-SW-44	1.06 (27)	6 (152)	0.07	(0.03)
1	SW	10A-SW-44	10C-SW-44	1.32 (34)	6 (152)	0.09	(0.04)
1¼	SW	12A-SW-44	12C-SW-44	1.67 (42)	6 (152)	0.11	(0.05)
1½	SW	15A-SW-44	15C-SW-44	1.91 (49)	6 (165)	0.13	(0.06)
2	SW	20A-SW-44	20C-SW-44	2.40 (61)	6 (152)	0.22	(0.10)
3	SW	30A-SW-44	30C-SW-44	3.52 (89)	6 (152)	0.32	(0.46)
4	SW	40A-SW-44	40C-SW-44	4.47 (114)	6 (152)	0.40	(0.18)
4	HW	40A-HW-44	40C-HW-44	4.52 (115)	6 (152)	0.60	(0.27)
5	SW	50A-SW-44	50C-SW-44	5.54 (141)	6 (152)	0.50	(0.23)
5	MW	50A-MW-44	50C-MW-44	5.59 (142)	6 (152)	0.65	(0.30)
5	HW	50A-HW-44	50C-HW-44	5.63 (143)	6 (152)	0.75	(0.34)
6	SW	60A-SW-44	60C-SW-44	6.61 (168)	6 (152)	0.55	(0.25)
6	MW	60A-MW-44	60C-MW-44	6.66 (169)	6 (152)	0.85	(0.39)
6	HW	60A-HW-44	60C-HW-44	6.69 (170)	6 (152)	0.95	(0.43)

Nominal Size	Type	ID Item No.		D	L	Weight	
		Belowground	Aboveground			lbs	kg
2	SW	20B-SW-44	20D-SW-44	2.16 (55)	6 (152)	0.18	(0.08)
2½	SW	25B-SW-44	25D-SW-44	2.66 (68)	6 (152)	0.22	(0.10)
3	SW	30B-SW-44	30D-SW-44	3.16 (80)	6 (152)	0.25	(0.11)
3½	SW	35B-SW-44	35D-SW-44	3.66 (93)	6 (152)	0.32	(0.15)
4	SW	40B-SW-44	40D-SW-44	4.16 (106)	6 (152)	0.36	(0.16)
4	HW	40B-HW-44	40D-HW-44	4.20 (107)	6 (152)	0.48	(0.22)
4½	SW	45B-SW-44	45D-SW-44	4.66 (118)	6 (152)	0.40	(0.18)
4½	HW	45B-HW-44	45D-HW-44	4.70 (119)	6 (152)	0.56	(0.25)
5	SW	50B-SW-44	50D-SW-44	5.16 (131)	6 (152)	0.45	(0.20)
5	MW	50B-MW-44	50D-MW-44	5.20 (132)	6 (152)	0.63	(0.29)
5	HW	50B-HW-44	50D-HW-44	5.24 (133)	6 (152)	0.73	(0.33)
6	SW	60B-SW-44	60D-SW-44	6.16 (156)	6 (152)	0.50	(0.23)
6	MW	60B-MW-44	60D-MW-44	6.20 (157)	6 (152)	0.85	(0.39)
6	HW	60B-HW-44	60D-HW-44	6.24 (158)	6 (152)	1.20	(0.55)

Nominal Size	Type	Item No.		D	L	Weight	
		Belowground	Aboveground			lbs	kg
2	XW	20B-XW-44	20D-XW-44	2.520 (64)	6 (152)	0.55	(0.25)
2½	XW	25B-XW-44	25D-XW-44	3.025 (77)	6 (152)	0.77	(0.35)
3	XW	30B-XW-44	30D-XW-44	3.520 (89)	6 (152)	0.89	(0.40)
3½	XW	35B-XW-44	35D-XW-44	4.025 (102)	6 (152)	1.02	(0.51)
4	XW	40B-XW-44	40D-XW-44	4.520 (115)	10 (254)	1.53	(0.67)
5	XW	50B-XW-44	50D-XW-44	5.520 (140)	10 (254)	2.17	(0.98)
6	XW	60B-XW-44	60D-XW-44	6.520 (166)	10 (254)	2.55	(1.16)

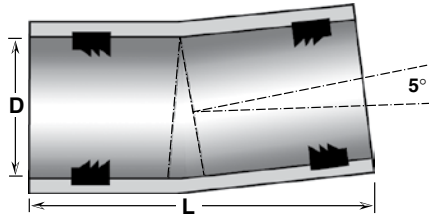

5° DOUBLE BELL COUPLING WITH GASKET

Other angles can also be manufactured, such as 2.5° etc. Please contact factory for consultation.

Nominal Size	Type	IPS Item No.		D	L	Weight	
		Belowground	Aboveground			lbs	kg
¾	SW	07A-SW-44-G	07C-SW-44-G	1.06 (27)	8 (203)	0.07 (0.03)	
1	SW	10A-SW-44-G	10C-SW-44-G	1.32 (34)	8 (203)	0.09 (0.04)	
1¼	SW	12A-SW-44-G	12C-SW-44-G	1.67 (42)	8 (203)	0.11 (0.05)	
1½	SW	15A-HW-44-G	15C-HW-44-G	1.91 (49)	8 (203)	0.13 (0.06)	
2	SW	20A-SW-44-G	20C-SW-44-G	2.40 (61)	8 (203)	0.72 (0.33)	
3	SW	30A-SW-44-G	30C-SW-44-G	3.52 (89)	8 (203)	0.99 (0.45)	
4	SW	40A-SW-44-G	40C-SW-44-G	4.47 (114)	8 (203)	1.35 (0.61)	
4	HW	40A-HW-44-G	40C-HW-44-G	4.52 (115)	8 (203)	1.45 (0.66)	
5	SW	50A-SW-44-G	50C-SW-44-G	5.54 (141)	8 (203)	1.65 (0.75)	
5	MW	50A-MW-44-G	50C-MW-44-G	5.59 (142)	8 (203)	1.85 (0.84)	
5	HW	50A-HW-44-G	50C-HW-44-G	5.63 (143)	8 (203)	1.95 (0.89)	
6	SW	60A-SW-44-G	60C-SW-44-G	6.61 (168)	8 (203)	2.05 (0.93)	
6	MW	60A-MW-44-G	60C-MW-44-G	6.66 (169)	8 (203)	2.15 (0.98)	
6	HW	60A-HW-44-G	60C-HW-44-G	6.69 (170)	8 (203)	2.45 (1.11)	

Nominal Size	Type	ID Item No.		D	L	Weight	
		Belowground	Aboveground			lbs	kg
2	SW	20B-SW-44-G	20D-SW-44-G	2.16 (55)	8 (203)	0.68 (0.31)	
2½	SW	25B-SW-44-G	25D-SW-44-G	2.66 (68)	8 (203)	0.85 (0.39)	
3	SW	30B-SW-44-G	30D-SW-44-G	3.16 (80)	8 (203)	1.00 (0.45)	
3½	SW	35B-SW-44-G	35D-SW-44-G	3.66 (93)	8 (203)	1.20 (0.55)	
4	SW	40B-SW-44-G	40D-SW-44-G	4.16 (106)	8 (203)	1.40 (0.64)	
4	HW	40B-HW-44-G	40D-HW-44-G	4.20 (107)	8 (203)	1.50 (0.68)	
4½	SW	45B-SW-44-G	45D-SW-44-G	4.66 (118)	8 (203)	1.60 (0.73)	
4½	HW	45B-HW-44-G	45D-HW-44-G	4.70 (119)	8 (203)	1.60 (0.73)	
5	SW	50B-SW-44-G	50D-SW-44-G	5.16 (131)	8 (203)	1.70 (0.77)	
5	MW	50B-MW-44-G	50D-MW-44-G	5.20 (132)	8 (203)	1.80 (0.82)	
5	HW	50B-HW-44-G	50D-HW-44-G	5.24 (133)	8 (203)	1.90 (0.86)	
6	SW	60B-SW-44-G	60D-SW-44-G	6.16 (156)	8 (203)	1.90 (0.86)	
6	MW	60B-MW-44-G	60D-MW-44-G	6.20 (157)	8 (203)	2.00 (0.91)	
6	HW	60B-HW-44-G	60D-HW-44-G	6.24 (158)	8 (203)	2.00 (0.91)	

EXPANSION JOINTS

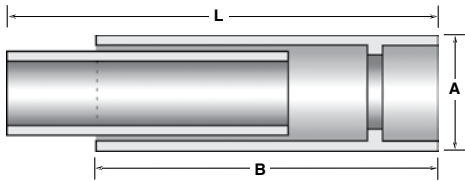

SINGLE EXPANSION JOINT SOCKET X SPIGOT, NO O-RING

Installation of Expansion Joints:

- When the duct is shorter than 50 ft., no Expansion Joint needed
- When the duct is between 50 ft. up to 200 ft., install one Expansion Joint at the mid point
- If the duct is longer than 200 ft., install one Expansion Joint every 200 ft. apart

Note: All Expansion Joints have a yellow line on the nipple end of the joint for proper installation.

Nominal Size	Type	IPS Item No.		A	B	L - Min	L - Max	Weight	
		Belowground	Aboveground					lbs	kg
¾	SW	07A-SW-34	07C-SW-34	1.20 (30)	12 (305)	15 (381)	23 (584)	0.39 (0.18)	
1	SW	10A-SW-34	10C-SW-34	1.46 (37)	12 (305)	15 (381)	23 (584)	0.44 (0.20)	
1¼	SW	12A-SW-34	12C-SW-34	1.81 (46)	12 (305)	15 (381)	23 (584)	0.53 (0.24)	
1½	SW	15A-SW-34	15C-SW-34	2.04 (52)	12 (305)	15 (381)	23 (584)	0.76 (0.35)	
2	SW	20A-SW-34	20C-SW-34	2.54 (65)	12 (305)	15 (381)	23 (584)	0.87 (0.40)	
3	SW	30A-SW-34	30C-SW-34	3.66 (93)	12 (305)	15 (381)	23 (584)	1.38 (0.63)	
4	SW	40A-SW-34	40C-SW-34	4.61 (117)	12 (305)	15 (381)	23 (584)	1.66 (0.75)	
4	HW	40A-HW-34	40C-HW-34	4.69 (119)	12 (305)	15 (381)	23 (584)	2.23 (1.01)	
5	SW	50A-SW-34	50C-SW-34	5.68 (144)	12 (305)	15 (381)	23 (584)	2.07 (0.94)	
5	MW	50A-MW-34	50C-MW-34	5.79 (147)	12 (305)	15 (381)	23 (584)	2.76 (1.25)	
5	HW	50A-HW-34	50C-HW-34	5.85 (149)	12 (305)	15 (381)	23 (584)	2.99 (1.36)	
6	SW	60A-SW-34	60C-SW-34	6.75 (171)	12 (305)	15 (381)	23 (584)	2.30 (1.04)	
6	MW	60A-MW-34	60C-MW-34	6.85 (174)	12 (305)	15 (381)	23 (584)	3.27 (1.49)	
6	HW	60A-HW-34	60C-HW-34	6.91 (176)	12 (305)	15 (381)	23 (584)	3.75 (1.70)	

Nominal Size	Type	ID Item No.		A	B	L - Min	L - Max	Weight	
		Belowground	Aboveground					lbs	kg
2	SW	20B-SW-34	20D-SW-34	2.30 (58)	12 (305)	15 (381)	23 (584)	0.78 (0.35)	
2½	SW	20B-SW-34	20D-SW-34	2.80 (71)	12 (305)	15 (381)	23 (584)	0.97 (0.44)	
3	SW	30B-SW-34	30D-SW-34	3.30 (84)	12 (305)	15 (381)	23 (584)	1.10 (0.50)	
3½	SW	35B-SW-34	35D-SW-34	3.80 (96)	12 (305)	15 (381)	23 (584)	1.38 (0.63)	
4	SW	40B-SW-34	40D-SW-34	4.30 (109)	12 (305)	15 (381)	23 (584)	1.59 (0.72)	
4	HW	40B-HW-34	40D-HW-34	4.39 (111)	12 (305)	15 (381)	23 (584)	2.12 (0.96)	
4½	SW	45B-SW-34	45D-SW-34	4.80 (122)	12 (305)	15 (381)	23 (584)	1.73 (0.79)	
4½	HW	45B-HW-34	45D-HW-34	4.89 (124)	12 (305)	15 (381)	23 (584)	2.39 (1.09)	
5	SW	50B-SW-34	50D-SW-34	5.30 (135)	12 (305)	15 (381)	23 (584)	1.96 (0.89)	
5	MW	50B-MW-34	50D-MW-34	5.39 (137)	12 (305)	15 (381)	23 (584)	2.60 (1.18)	
5	HW	50B-HW-34	50D-HW-34	5.42 (138)	12 (305)	15 (381)	23 (584)	3.04 (1.38)	
6	SW	60B-SW-34	60D-SW-34	6.30 (160)	12 (305)	15 (381)	23 (584)	2.35 (1.07)	
6	MW	60B-MW-34	60D-MW-34	6.39 (162)	12 (305)	15 (381)	23 (584)	3.11 (1.41)	
6	HW	60B-HW-34	60D-HW-34	6.42 (163)	12 (305)	15 (381)	23 (584)	3.63 (1.65)	

Nominal Size	Type	Item No.		A	B	L - Min	L - Max	Weight	
		Belowground	Aboveground					lbs	kg
2	XW	20B-XW-34	20D-XW-34	3.000 (76)	12 (305)	15 (381)	23 (584)	2.90 (1.32)	
2½	XW	25B-XW-34	25D-XW-34	3.525 (90)	12 (305)	15 (381)	23 (584)	3.56 (1.61)	
3	XW	30B-XW-34	30D-XW-34	4.000 (102)	12 (305)	15 (381)	23 (584)	4.19 (1.90)	
3½	XW	35B-XW-34	35D-XW-34	4.525 (115)	12 (305)	15 (381)	23 (584)	4.83 (2.19)	
4	XW	40B-XW-34	40D-XW-34	5.000 (127)	14 (356)	19 (482)	27 (686)	6.42 (2.92)	
5	XW	50B-XW-34	50D-XW-34	6.000 (152)	14 (356)	19 (482)	27 (686)	7.94 (3.60)	
6	XW	60B-XW-34	60D-XW-34	7.000 (178)	14 (356)	19 (482)	27 (686)	10.06 (4.57)	
8	XW	80A-XW-34	80C-XW-34	9.420 (239)	14 (356)	19 (482)	27 (686)	13.80 (6.27)	

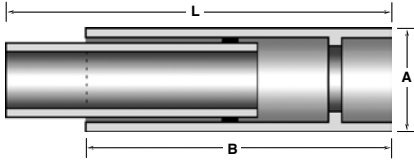

SINGLE EXPANSION JOINT SOCKET X SPIGOT WITH O-RING

Installation of Expansion Joints:

- When the duct is shorter than 50 ft., no Expansion Joint needed
- When the duct is between 50 ft. up to 200 ft., install one Expansion Joint at the mid point
- If the duct is longer than 200 ft., install one Expansion Joint every 200 ft. apart

Note: All Expansion Joints have a yellow line on the nipple end of the joint for proper installation.

Nominal Size	Type	IPS Item No.		A	B	L - Min	L - Max	Weight	
		Belowground	Aboveground					lbs	kg
¾	SW	07A-SW-36	07C-SW-36	1.20 (30)	12 (305)	15 (381)	23 (584)	0.39	(0.18)
1	SW	10A-SW-36	10C-SW-36	1.46 (37)	12 (305)	15 (381)	23 (584)	0.44	(0.20)
1¼	SW	12A-SW-36	12C-SW-36	1.81 (46)	12 (305)	15 (381)	23 (584)	0.53	(0.24)
1½	SW	15A-SW-36	15C-SW-36	2.04 (52)	12 (305)	15 (381)	23 (584)	0.76	(0.35)
2	SW	20A-SW-36	20C-SW-36	2.54 (65)	12 (305)	15 (381)	23 (584)	0.87	(0.40)
3	SW	30A-SW-36	30C-SW-36	3.66 (93)	12 (305)	15 (381)	23 (584)	1.38	(0.63)
4	SW	40A-SW-36	40C-SW-36	4.61 (117)	12 (305)	15 (381)	23 (584)	1.66	(0.75)
4	HW	40A-HW-36	40C-HW-36	4.69 (119)	12 (305)	15 (381)	23 (584)	2.23	(1.01)
5	SW	50A-SW-36	50C-SW-36	5.68 (144)	12 (305)	15 (381)	23 (584)	2.07	(0.94)
5	MW	50A-MW-36	50C-MW-36	5.79 (147)	12 (305)	15 (381)	23 (584)	2.76	(1.25)
5	HW	50A-HW-36	50C-HW-36	5.85 (149)	12 (305)	15 (381)	23 (584)	2.99	(1.36)
6	SW	60A-SW-36	60C-SW-36	6.75 (171)	12 (305)	15 (381)	23 (584)	2.30	(1.04)
6	MW	60A-MW-36	60C-MW-36	6.85 (174)	12 (305)	15 (381)	23 (584)	3.27	(1.49)
6	HW	60A-HW-36	60C-HW-36	6.91 (176)	12 (305)	15 (381)	23 (584)	3.75	(1.70)

Nominal Size	Type	ID Item No.		A	B	L - Min	L - Max	Weight	
		Belowground	Aboveground					lbs	kg
2	SW	20B-SW-36	20D-SW-36	2.30 (58)	12 (305)	15 (381)	23 (584)	0.78	(0.35)
2½	SW	25B-SW-36	25D-SW-36	2.80 (71)	12 (305)	15 (381)	23 (584)	0.97	(0.44)
3	SW	30B-SW-36	30D-SW-36	3.30 (84)	12 (305)	15 (381)	23 (584)	1.10	(0.50)
3½	SW	35B-SW-36	35D-SW-36	3.80 (96)	12 (305)	15 (381)	23 (584)	1.38	(0.63)
4	SW	40B-SW-36	40D-SW-36	4.30 (109)	12 (305)	15 (381)	23 (584)	1.59	(0.72)
4	HW	40B-HW-36	40D-HW-36	4.39 (111)	12 (305)	15 (381)	23 (584)	2.12	(0.96)
4½	SW	45B-SW-36	45D-SW-36	4.80 (122)	12 (305)	15 (381)	23 (584)	1.73	(0.79)
4½	HW	45B-HW-36	45D-HW-36	4.89 (124)	12 (305)	15 (381)	23 (584)	2.39	(1.09)
5	SW	50B-SW-36	50D-SW-36	5.30 (135)	12 (305)	15 (381)	23 (584)	1.95	(0.89)
5	MW	50B-MW-36	50D-MW-36	5.39 (137)	12 (305)	15 (381)	23 (584)	2.60	(1.18)
5	HW	50B-HW-36	50D-HW-36	5.42 (138)	12 (305)	15 (381)	23 (584)	3.04	(1.38)
6	SW	60B-SW-36	60D-SW-36	6.30 (160)	12 (305)	15 (381)	23 (584)	2.35	(1.07)
6	MW	60B-MW-36	60D-MW-36	6.39 (162)	12 (305)	15 (381)	23 (584)	3.11	(1.41)
6	HW	60B-HW-36	60D-HW-36	6.42 (163)	12 (305)	15 (381)	23 (584)	3.63	(1.65)

Nominal Size	Type	Item No.		A	B	L - Min	L - Max	Weight	
		Belowground	Aboveground					lbs	kg
2	XW	20B-XW-36	20D-XW-36	3.000 (76)	12 (305)	15 (381)	23 (584)	2.90	(1.32)
2½	XW	25B-XW-36	25D-XW-36	3.525 (90)	12 (305)	15 (381)	23 (584)	3.56	(1.61)
3	XW	30B-XW-36	30D-XW-36	4.000 (102)	12 (305)	15 (381)	23 (584)	4.19	(1.90)
3½	XW	35B-XW-36	35D-XW-36	4.525 (115)	12 (305)	15 (381)	23 (584)	4.83	(2.19)
4	XW	40B-XW-36	40D-XW-36	5.000 (127)	14 (356)	19 (482)	27 (686)	6.42	(2.92)
5	XW	50B-XW-36	50D-XW-36	6.000 (152)	14 (356)	19 (482)	27 (686)	7.94	(3.60)
6	XW	60B-XW-36	60D-XW-36	7.000 (178)	14 (356)	19 (482)	27 (686)	10.06	(4.57)

Nominal Size	Type	IPS Item No.		A	B	L - Min	L - Max	Weight	
		Belowground	Aboveground					lbs	kg
¾	SW	07A-SW-35	07C-SW-35	1.20 (30)	12 (305)	18 (457)	26 (660)	0.49	(0.22)
1	SW	10A-SW-35	10C-SW-35	1.46 (37)	12 (305)	18 (457)	26 (660)	0.55	(0.25)
1¼	SW	12A-SW-35	12C-SW-35	1.81 (46)	12 (305)	18 (457)	26 (660)	0.66	(0.30)
1½	SW	15A-SW-35	15C-SW-35	2.04 (52)	12 (305)	18 (457)	26 (660)	0.76	(0.35)
2	SW	20A-SW-35	20C-SW-35	2.54 (65)	12 (305)	18 (457)	26 (660)	1.09	(0.50)
3	SW	30A-SW-35	30C-SW-35	3.66 (93)	12 (305)	18 (457)	26 (660)	1.73	(0.79)
4	SW	40A-SW-35	40C-SW-35	4.61 (117)	12 (305)	18 (457)	26 (660)	2.07	(0.94)
4	HW	40A-HW-35	40C-HW-35	4.69 (119)	12 (305)	18 (457)	26 (660)	2.79	(1.27)
5	SW	50A-SW-35	50C-SW-35	5.68 (144)	12 (305)	18 (457)	26 (660)	2.59	(1.18)
5	MW	50A-MW-35	50C-MW-35	5.79 (147)	12 (305)	18 (457)	26 (660)	3.45	(1.57)
5	HW	50A-HW-35	50C-HW-35	5.85 (149)	12 (305)	18 (457)	26 (660)	3.74	(1.70)
6	SW	60A-SW-35	60C-SW-35	6.75 (171)	12 (305)	18 (457)	26 (660)	2.88	(1.31)
6	MW	60A-MW-35	60C-MW-35	6.85 (174)	12 (305)	18 (457)	26 (660)	4.08	(1.85)
6	HW	60A-HW-35	60C-HW-35	6.91 (176)	12 (305)	18 (457)	26 (660)	4.69	(2.13)

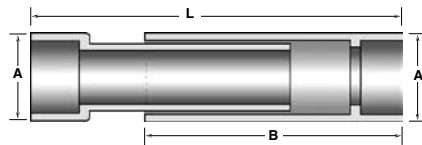

SINGLE EXPANSION JOINT SOCKET X SOCKET, NO O-RING

Same instructions & note as above

Nominal Size	Type	ID Item No.		A	B	L - Min	L - Max	Weight	
		Belowground	Aboveground					lbs	kg
2	SW	20B-SW-35	20D-SW-35	2.30 (58)	12 (305)	18 (457)	26 (660)	0.98	(0.45)
2½	SW	25B-SW-35	25D-SW-35	2.30 (58)	12 (305)	18 (457)	26 (660)	1.21	(0.55)
3	SW	30B-SW-35	30D-SW-35	3.30 (84)	12 (305)	18 (457)	26 (660)	1.38	(0.63)
3½	SW	35B-SW-35	35D-SW-35	3.80 (96)	12 (305)	18 (457)	26 (660)	1.73	(0.79)
4	SW	40B-SW-35	40D-SW-35	4.30 (109)	12 (305)	18 (457)	26 (660)	1.98	(0.90)
4	HW	40B-HW-35	40D-HW-35	4.39 (111)	12 (305)	18 (457)	26 (660)	2.65	(1.20)
4½	SW	45B-SW-35	45D-SW-35	4.80 (122)	12 (305)	18 (457)	26 (660)	2.16	(0.98)
4½	HW	45B-HW-35	45D-HW-35	4.89 (124)	12 (305)	18 (457)	26 (660)	2.99	(1.36)
5	SW	50B-SW-35	50D-SW-35	5.30 (135)	12 (305)	18 (457)	26 (660)	2.44	(1.11)
5	MW	50B-MW-35	50D-MW-35	5.39 (137)	12 (305)	18 (457)	26 (660)	3.25	(1.48)
5	HW	50B-HW-35	50D-HW-35	5.42 (138)	12 (305)	18 (457)	26 (660)	3.80	(1.73)
6	SW	60B-SW-35	60D-SW-35	6.30 (160)	12 (305)	18 (457)	26 (660)	2.93	(1.33)
6	MW	60B-MW-35	60D-MW-35	6.39 (162)	12 (305)	18 (457)	26 (660)	3.88	(1.76)
6	HW	60B-HW-35	60D-HW-35	6.42 (163)	12 (305)	18 (457)	26 (660)	4.54	(2.07)

Nominal Size	Type	Item No.		A	B	L - Min	L - Max	Weight	
		Belowground	Aboveground					lbs	kg
2	XW	20B-XW-35	20D-XW-35	3.000 (76)	12 (305)	18 (457)	26 (660)	3.62	(1.64)
2½	XW	25B-XW-35	25D-XW-35	3.525 (90)	12 (305)	15 (381)	23 (584)	4.44	(2.01)
3	XW	30B-XW-35	30D-XW-35	4.000 (102)	12 (305)	18 (457)	26 (660)	5.23	(2.37)
3½	XW	35B-XW-35	35D-XW-35	4.525 (115)	12 (305)	15 (381)	23 (584)	6.06	(2.75)
4	XW	40B-XW-35	40D-XW-35	5.000 (127)	14 (356)	22 (559)	32 (812)	7.89	(3.58)
5	XW	50B-XW-35	50D-XW-35	6.000 (152)	14 (356)	22 (559)	32 (812)	9.75	(4.43)
6	XW	60B-XW-35	60D-XW-35	7.000 (178)	14 (356)	22 (559)	32 (812)	12.08	(5.48)

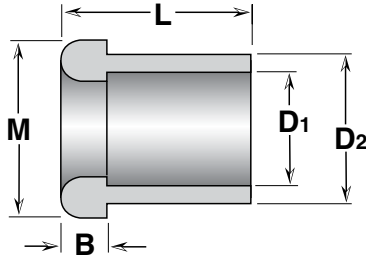

END BELLS-SOCKET TYPE

End bells are used for creating a permanent termination into a box as well as having a smooth surface that the cable can be pulled over.

Nominal Size	Type	IPS Item No.		D1	D2	L	M	B	Weight	
		Belowground	Aboveground						lbs	kg
¾	SW	07A-SW-29	07C-SW-29	1.06 (27)	1.20 (30)	1.60 (41)	1.50 (38)	0.25 (6)	0.10 (0.05)	
1	SW	10A-SW-29	10C-SW-29	1.32 (34)	1.46 (37)	1.60 (41)	2.50 (64)	0.50 (13)	0.10 (0.05)	
1¼	SW	12A-SW-29	12C-SW-29	1.67 (42)	1.81 (46)	1.60 (41)	3.00 (76)	0.50 (13)	0.15 (0.07)	
1½	SW	15A-SW-29	15C-SW-29	1.91 (49)	2.04 (52)	1.60 (41)	3.25 (83)	0.50 (13)	0.20 (0.09)	
2	SW	20A-SW-29	20C-SW-29	2.40 (61)	2.54 (61)	3.00 (76)	3.75 (95)	0.50 (13)	0.40 (0.18)	
3	SW	30A-SW-29	30C-SW-29	3.52 (89)	3.66 (93)	3.00 (76)	5.37 (137)	0.50 (13)	0.45 (0.20)	
4	SW	40A-SW-29	40C-SW-29	4.47 (114)	4.61 (117)	3.00 (76)	6.50 (165)	0.75 (19)	0.80 (0.36)	
4	HW	40A-HW-29	40C-HW-29	4.52 (115)	4.69 (119)	3.00 (76)	6.50 (165)	0.75 (19)	0.85 (0.38)	
5	SW	50A-SW-29	50C-SW-29	5.54 (141)	5.68 (144)	3.00 (76)	7.37 (187)	0.75 (19)	0.90 (0.41)	
5	MW	50A-MW-29	50C-MW-29	5.59 (142)	5.79 (147)	3.00 (76)	7.37 (187)	0.75 (19)	0.95 (0.43)	
5	HW	50A-HW-29	50C-HW-29	5.63 (143)	5.85 (149)	3.00 (76)	7.37 (187)	0.75 (19)	1.00 (0.45)	
6	SW	60A-SW-29	60C-SW-29	6.61 (168)	6.68 (170)	3.00 (76)	8.50 (216)	0.75 (19)	1.05 (0.48)	
6	MW	60A-MW-29	60C-MW-29	6.66 (169)	6.79 (172)	3.00 (76)	8.50 (216)	0.75 (19)	1.10 (0.50)	
6	HW	60A-HW-29	60C-HW-29	6.69 (170)	6.85 (174)	3.00 (76)	8.50 (216)	0.75 (19)	1.15 (0.52)	

Nominal Size	Type	ID Item No.		D1	D2	L	M	B	Weight	
		Belowground	Aboveground						lbs	kg
2	SW	20B-SW-29	20D-SW-29	2.16 (55)	2.30 (58)	3.00 (76)	3.62 (92)	0.50 (13)	0.40 (0.18)	
2½	SW	25B-SW-29	25D-SW-29	2.66 (68)	2.80 (71)	3.00 (76)	4.00 (102)	0.50 (13)	0.45 (0.20)	
3	SW	30B-SW-29	30D-SW-29	3.16 (80)	3.30 (84)	3.00 (76)	5.00 (127)	0.50 (13)	0.55 (0.25)	
3½	SW	35B-SW-29	35D-SW-29	3.66 (93)	3.80 (96)	3.00 (76)	5.50 (140)	0.50 (13)	0.60 (0.27)	
4	SW	40B-SW-29	40D-SW-29	4.16 (106)	4.30 (109)	3.00 (76)	6.00 (153)	0.75 (19)	0.78 (0.35)	
4	HW	40B-HW-29	40D-HW-29	4.20 (107)	4.39 (111)	3.00 (76)	6.00 (153)	0.75 (19)	0.95 (0.43)	
5	SW	50B-SW-29	50D-SW-29	5.16 (131)	5.30 (135)	3.00 (76)	7.00 (178)	0.75 (19)	0.80 (0.36)	
5	MW	50B-MW-29	50D-MW-29	5.20 (132)	5.39 (137)	3.00 (76)	7.00 (178)	0.75 (19)	0.85 (0.39)	
5	HW	50B-HW-29	50D-HW-29	5.24 (133)	5.42 (138)	3.00 (76)	7.00 (178)	0.75 (19)	0.87 (0.40)	
6	SW	60B-SW-29	60D-SW-29	6.16 (156)	6.30 (160)	3.00 (76)	8.00 (203)	0.75 (19)	0.95 (0.43)	
6	MW	60B-MW-29	60D-MW-29	6.20 (157)	6.39 (162)	3.00 (76)	8.00 (203)	0.75 (19)	1.15 (0.52)	
6	HW	60B-HW-29	60D-HW-29	6.24 (158)	6.42 (163)	3.00 (76)	8.00 (203)	0.75 (19)	1.25 (0.57)	

Nominal Size	Type	Item No.		D1	D2	L	M	B	Weight	
		Belowground	Aboveground						lbs	kg
2	XW	20B-XW-29	20D-XW-29	2.520 (64)	3.020 (76)	3.00 (76)	3.62 (92)	0.50 (13)	1.30 (0.59)	
2½	XW	25B-XW-29	25D-XW-29	3.025 (77)	3.525 (90)	3.00 (76)	4.00 (102)	0.50 (13)	1.59 (0.72)	
3	XW	30B-XW-29	30D-XW-29	3.520 (89)	4.020 (102)	3.00 (76)	5.00 (127)	0.50 (13)	1.90 (0.86)	
3½	XW	35B-XW-29	35D-XW-29	4.025 (102)	4.525 (115)	3.00 (76)	5.50 (140)	0.50 (13)	2.17 (0.98)	
4	XW	40B-XW-29	40D-XW-29	4.520 (115)	5.020 (128)	3.00 (76)	6.00 (153)	0.75 (19)	2.40 (1.09)	
5	XW	50B-XW-29	50D-XW-29	5.520 (140)	6.020 (153)	3.00 (76)	7.00 (178)	0.75 (19)	2.42 (1.10)	
6	XW	60B-XW-29	60D-XW-29	6.520 (166)	7.020 (178)	3.00 (76)	8.00 (203)	0.75 (19)	2.50 (1.13)	

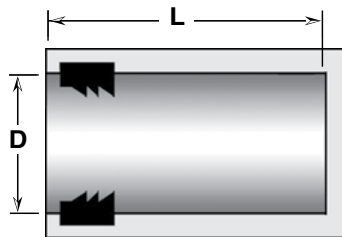

FIBERGLASS END CAP WITH GASKET

Nominal Size	Type	IPS Item No.		D	L	Weight	
		Belowground	Aboveground			lbs	kg
2	SW	20A-SW-23-G	20C-SW-23-G	2.40 (61)	4 (102)	0.70 (0.32)	
3	SW	30A-SW-23-G	30C-SW-23-G	3.52 (89)	4 (102)	0.95 (0.43)	
4	SW	40A-SW-23-G	40C-SW-23-G	4.47 (114)	4 (102)	1.30 (0.59)	
4	HW	40A-HW-23-G	40C-HW-23-G	4.52 (115)	4 (102)	1.40 (0.64)	
5	SW	50A-SW-23-G	50C-SW-23-G	5.54 (141)	4 (102)	1.60 (0.73)	
5	MW	50A-MW-23-G	50C-MW-23-G	5.59 (142)	4 (102)	1.80 (0.82)	
5	HW	50A-HW-23-G	50C-HW-23-G	5.63 (143)	4 (102)	1.90 (0.86)	
6	SW	60A-SW-23-G	60C-SW-23-G	6.61 (168)	4 (102)	2.00 (0.91)	
6	MW	60A-MW-23-G	60C-MW-23-G	6.66 (169)	4 (102)	2.10 (0.95)	
6	HW	60A-HW-23-G	60C-HW-23-G	6.69 (170)	4 (102)	2.40 (1.09)	

Nominal Size	Type	ID Item No.		D	L	Weight	
		Belowground	Aboveground			lbs	kg
2	SW	20B-SW-23-G	20D-SW-23-G	2.16 (55)	4 (102)	0.70 (0.32)	
2½	SW	25B-SW-23-G	25D-SW-23-G	2.66 (68)	4 (102)	0.80 (0.36)	
3	SW	30B-SW-23-G	30D-SW-23-G	3.16 (80)	4 (102)	0.95 (0.43)	
3½	HW	35B-SW-23-G	35D-SW-23-G	3.66 (93)	4 (102)	1.20 (0.55)	
4	SW	40B-SW-23-G	40D-SW-23-G	4.16 (106)	4 (102)	1.30 (0.59)	
4	HW	40B-HW-23-G	40D-HW-23-G	4.20 (107)	4 (102)	1.40 (0.64)	
4½	SW	45B-SW-23-G	45D-SW-23-G	4.66 (118)	4 (102)	1.50 (0.68)	
4½	HW	45B-HW-23-G	45D-HW-23-G	4.70 (119)	4 (102)	1.60 (0.73)	
5	SW	50B-SW-23-G	50D-SW-23-G	5.16 (131)	4 (102)	1.60 (0.73)	
5	MW	50B-MW-23-G	50D-MW-23-G	5.20 (132)	4 (102)	1.70 (0.77)	
5	HW	50B-HW-23-G	50D-HW-23-G	5.24 (133)	4 (102)	1.80 (0.82)	
6	SW	60B-SW-23-G	60D-SW-23-G	6.16 (156)	4 (102)	1.90 (0.86)	
6	MW	60B-MW-23-G	60D-MW-23-G	6.20 (157)	4 (102)	1.90 (0.86)	
6	HW	60B-HW-23-G	60D-HW-23-G	6.24 (158)	4 (102)	2.00 (0.91)	

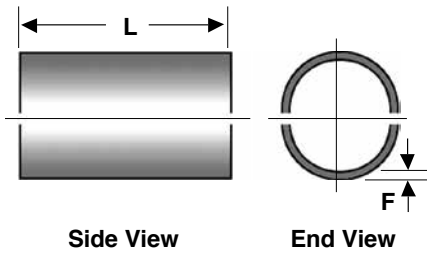

SPLIT ANCHOR RINGS

Split anchor rings are always supplied in pairs and are used for above ground installations in order to create fixed points. The split anchor rings are placed around the hanger closest to the mid point between two expansion joints. One pair of split anchor rings is placed on each side of the hanger. The split anchor rings are bonded with epoxy adhesive to the outside of the conduit. The hanger where split anchor rings are used is called an anchor hanger and is normally braced, see Champion Hanger section in this catalog.

Nominal Size	Type	IPS Item No.		ID Item No.		F	L	Weight	
		Belowground	Aboveground	Belowground	Aboveground			lbs	kg
¾	SW	07A-SW-28	07C-SW-28	—	—	0.25 (6)	3 (76)	0.18	(0.08)
1	SW	10A-SW-28	10C-SW-28	—	—	0.25 (6)	3 (76)	0.21	(0.10)
1¼	SW	12A-SW-28	12C-SW-28	—	—	0.25 (6)	3 (76)	0.26	(0.12)
1½	SW	15A-SW-28	15C-SW-28	—	—	0.25 (6)	3 (76)	0.36	(0.16)
2	SW	20A-SW-28	20C-SW-28	20B-SW-28	20D-SW-28	0.25 (6)	3 (76)	0.42	(0.19)
2½	SW	25A-SW-28	25C-SW-28	25B-SW-28	25D-SW-28	0.25 (6)	3 (76)	0.48	(0.22)
3	SW	30A-SW-28	30C-SW-28	30B-SW-28	30D-SW-28	0.25 (6)	3 (76)	0.67	(0.30)
3½	SW	—	—	35B-SW-28	35D-SW-28	0.25 (6)	3 (76)	0.76	(0.34)
4	SW	40A-SW-28	40C-SW-28	40B-SW-28	40D-SW-28	0.25 (6)	3 (76)	0.80	(0.36)
4	HW	40A-HW-28	40C-HW-28	40B-HW-28	40D-HW-28	0.25 (6)	3 (76)	0.80	(0.36)
4½	SW	45A-SW-28	45C-SW-28	45B-SW-28	45D-SW-28	0.25 (6)	3 (76)	0.91	(0.41)
4½	HW	45A-HW-28	45C-HW-28	45B-HW-28	45D-HW-28	0.25 (6)	3 (76)	0.91	(0.41)
5	SW	50A-SW-28	50C-SW-28	50B-SW-28	50D-SW-28	0.25 (6)	3 (76)	1.06	(0.48)
5	MW	50A-MW-28	50C-MW-28	50B-MW-28	50D-MW-28	0.25 (6)	3 (76)	1.06	(0.48)
5	HW	50A-HW-28	50C-HW-28	50B-HW-28	50D-HW-28	0.25 (6)	3 (76)	1.06	(0.48)
6	SW	60A-SW-28	60C-SW-28	60B-SW-28	60D-SW-28	0.25 (6)	3 (76)	1.15	(0.52)
6	MW	60A-MW-28	60C-MW-28	60B-MW-28	60D-MW-28	0.25 (6)	3 (76)	1.15	(0.52)
6	HW	60A-HW-28	60C-HW-28	60B-HW-28	60D-HW-28	0.25 (6)	3 (76)	1.15	(0.52)

Nominal Size	Type	Item No.		F	L	Weight	
		Belowground	Aboveground			lbs	kg
2	XW	20B-XW-28	20D-XW-28	0.25 (6)	3 (76)	0.52	(0.24)
2½	XW	25B-XW-28	25D-XW-28	0.25 (6)	3 (76)	0.64	(0.29)
3	XW	30B-XW-28	30D-XW-28	0.25 (6)	3 (76)	0.80	(0.36)
3½	XW	35B-XW-28	35D-XW-28	0.25 (6)	3 (76)	0.87	(0.39)
4	XW	40B-XW-28	40D-XW-28	0.25 (6)	3 (76)	0.98	(0.44)
5	XW	50B-XW-28	50D-XW-28	0.25 (6)	3 (76)	1.15	(0.52)
6	XW	60B-XW-28	60D-XW-28	0.25 (6)	3 (76)	1.25	(0.57)

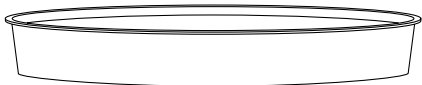

THERMOPLASTIC PLUG

Nominal Size	Type	IPS Item No.		ID Item No.		Weight	
		Belowground	Aboveground	Belowground	Aboveground	lbs	kg
¾	SW	07A-SW-26	07C-SW-26	—	—	0.01	(0.005)
1	SW	10A-SW-26	10C-SW-26	—	—	0.01	(0.005)
1¼	SW	12A-SW-26	12C-SW-26	—	—	0.01	(0.005)
1½	SW	15A-SW-26	15C-SW-26	—	—	0.01	(0.005)
2	SW	20A-SW-26	20C-SW-26	20B-SW-26	20D-SW-26	0.01	(0.005)
2½	SW	25A-SW-26	25C-SW-26	25B-SW-26	25D-SW-26	0.01	(0.005)
3	SW	30A-SW-26	30C-SW-26	30B-SW-26	30D-SW-26	0.03	(0.014)
3½	SW	—	—	35B-SW-26	35D-SW-26	0.03	(0.014)
4	SW	40A-SW-26	40C-SW-26	40B-SW-26	40D-SW-26	0.03	(0.014)
4	HW	40A-HW-26	40C-HW-26	40B-HW-26	40D-HW-26	0.03	(0.014)
4½	SW	45A-SW-26	45C-SW-26	45B-SW-26	45D-SW-26	0.05	(0.023)
4½	HW	45A-HW-26	45C-HW-26	45B-HW-26	45D-HW-26	0.05	(0.023)
5	SW	50A-SW-26	50C-SW-26	50B-SW-26	50D-SW-26	0.06	(0.027)
5	MW	50A-MW-26	50C-MW-26	50B-MW-26	50D-MW-26	0.06	(0.027)
5	HW	50A-HW-26	50C-HW-26	50B-HW-26	50D-HW-26	0.06	(0.027)
6	SW	60A-SW-26	60C-SW-26	60B-SW-26	60D-SW-26	0.07	(0.032)
6	MW	60A-MW-26	60C-MW-26	60B-MW-26	60D-MW-26	0.07	(0.032)
6	HW	60A-HW-26	60C-HW-26	60B-HW-26	60D-HW-26	0.07	(0.032)

Nominal Size	Type	Item No.	Weight	
			lbs	kg
2	XW	20D-XW-26	0.01	(0.005)
2½	XW	25D-XW-26	0.01	(0.005)
3	XW	30D-XW-26	0.03	(0.014)
3½	XW	35D-XW-26	0.03	(0.014)
4	XW	40D-XW-26	0.03	(0.014)
5	XW	50D-XW-26	0.06	(0.027)
6	XW	60D-XW-26	0.07	(0.032)

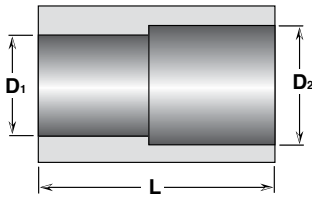

REDUCING ADAPTER

Transition adapter from ID/tubular fiberglass conduit to IPS type and PVC schedule 40 and 80.

Nominal Size	Type	Item No.		D1	D2	L	Weight	
		Belowground	Aboveground				lbs	kg
2	SW	20B-SW-27	20D-SW-27	2.16 (55)	2.40 (61)	6 (152)	0.30	0.14
3	SW	30B-SW-27	30D-SW-27	3.16 (80)	3.52 (89)	6 (152)	0.50	0.23
4	SW	40B-SW-27	40D-SW-27	4.16 (106)	4.47 (114)	6 (152)	0.60	0.27
4	HW	40B-HW-27	40D-HW-27	4.20 (107)	4.52 (115)	6 (152)	0.70	0.32
5	SW	50B-SW-27	50D-SW-27	5.16 (131)	5.54 (141)	6 (152)	0.70	0.32
5	MW	50B-MW-27	50D-MW-27	5.20 (132)	5.59 (142)	6 (152)	0.90	0.41
5	HW	50B-HW-27	50D-HW-27	5.24 (133)	5.63 (143)	6 (152)	1.00	0.45
6	SW	60B-SW-27	60D-SW-27	6.16 (156)	6.61 (168)	6 (152)	0.80	0.36
6	MW	60B-MW-27	60D-MW-27	6.20 (157)	6.66 (169)	6 (152)	1.10	0.50
6	HW	60B-HW-27	60D-HW-27	6.24 (158)	6.69 (170)	6 (152)	1.20	0.55

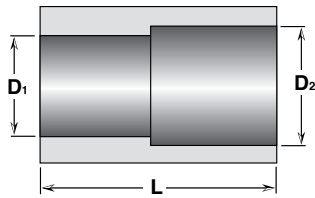

REDUCING ADAPTER

This adapter is used for transition between different diameters of fiberglass conduit.

Nominal Size	IPS Item No.	Belowground	Aboveground	D1	D2	L	Weight	
							lbs	kg
¾ SW - ½ SW	07A-SW-25-05A	07C-SW-25-05C	0.87 (22)	1.06 (27)	4 (101)	0.30	0.14	
1 SW - ½ SW	10A-SW-25-05A	10C-SW-25-05C	0.87 (22)	1.32 (34)	4 (101)	0.40	0.18	
1 SW - ¾ SW	10A-SW-25-07A	10C-SW-25-07C	1.06 (27)	1.32 (34)	4 (101)	0.35	0.16	
1¼ SW - ¾ SW	12A-SW-25-07A	12C-SW-25-07C	1.06 (27)	1.67 (42)	4 (101)	0.45	0.20	
1¼ SW - 1 SW	12A-SW-25-10A	12C-SW-25-10C	1.32 (34)	1.67 (42)	4 (101)	0.40	0.18	
1½ SW - ¾ SW	15A-SW-25-07A	15C-SW-25-07C	1.06 (27)	1.91 (48)	4 (101)	0.38	0.17	
1½ SW - 1 SW	15A-SW-25-10A	15C-SW-25-10C	1.32 (34)	1.91 (48)	4 (101)	0.40	0.18	
1½ SW - 1¼ SW	15A-SW-25-12A	15C-SW-25-12C	1.67 (42)	1.91 (48)	6 (152)	0.37	0.17	
2 SW - ¾ SW	20A-SW-25-07A	20C-SW-25-07C	1.06 (27)	2.40 (61)	6 (152)	0.60	0.27	
2 SW - 1 SW	20A-SW-25-10A	20C-SW-25-10C	1.32 (34)	2.40 (61)	6 (152)	0.55	0.25	
2 SW - 1¼ SW	20A-SW-25-12A	20C-SW-25-12C	1.67 (42)	2.40 (61)	6 (152)	0.50	0.23	
2 SW - 1½ SW	20A-SW-25-15A	20C-SW-25-15C	1.91 (48)	2.40 (61)	6 (152)	0.47	0.21	
3 SW - 2 SW	30A-SW-25-20A	30C-SW-25-20C	2.40 (61)	3.52 (89)	6 (152)	0.65	0.32	
4 SW - 2 SW	40A-SW-25-20A	40C-SW-25-20C	2.40 (61)	4.47 (113)	6 (152)	0.80	0.36	
4 SW - 3 SW	40A-SW-25-30A	40C-SW-25-30C	3.52 (89)	4.47 (113)	6 (152)	0.90	0.41	
5 SW - 3 SW	50A-SW-25-30A	50C-SW-25-30C	3.52 (89)	5.59 (142)	6 (152)	1.30	0.59	
5 SW - 4 SW	50A-SW-25-40A	50C-SW-25-40C	4.47 (114)	5.59 (142)	6 (152)	0.85	0.39	
6 SW - 4 SW	60A-SW-25-40A	60C-SW-25-40C	4.47 (114)	6.61 (166)	6 (152)	1.70	0.77	
6 MW - 5 SW	60A-MW-25-50A	60C-MW-25-50C	5.59 (142)	6.61 (166)	6 (152)	1.90	0.86	

Note: These are just examples of some reducing adapters. Contact Champion Fiberglass directly for other reducers.

OFFSET BEND

When manufacturing offset bends, the vertical offset dimension, H, and the horizontal offset dimension, L, must be provided.

All offset bends are supplied with 6" (152mm) straight ends. (Item numbers for offset bends end with the suffix - 47.)

Contact your local sales representative or Champion Fiberglass for additional information.

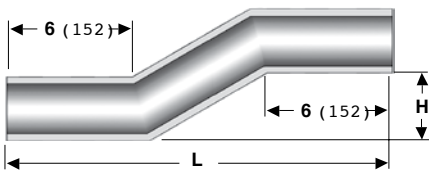

WOBBLE COUPLING

Wobble couplings are used for minor vertical and horizontal offsets for above ground installations. (Item numbers for wobble couplings end with the suffix - 48.)

For additional information regarding dimensions, etc., please contact your local sales representative or Champion Fiberglass directly.

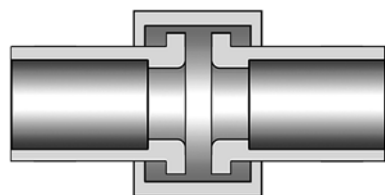

FITTINGS

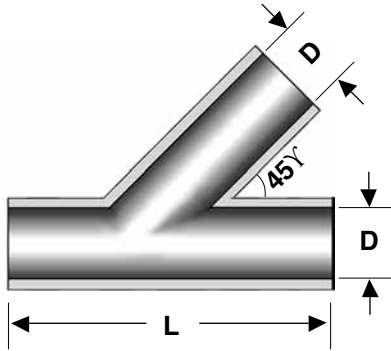

Y - FITTING

Special fitting not sold in US.

Nominal Size	Type	IPS Item No.		D	L	Weight	
		Belowground	Aboveground			lbs	kg
3/4	SW	07A-SW-45	07C-SW-45	1.06 (27)	15 (381)	0.54	(0.25)
1	SW	10A-SW-45	10C-SW-45	1.32 (34)	15 (381)	0.60	(0.27)
1 1/4	SW	12A-SW-45	12C-SW-45	1.67 (42)	15 (381)	0.70	(0.32)
1 1/2	SW	15A-SW-45	15C-SW-45	1.91 (49)	15 (381)	0.76	(0.35)
2	SW	20A-SW-45	20C-SW-45	2.40 (61)	18 (457)	1.06	(0.48)
3	SW	30A-SW-45	30C-SW-45	3.52 (89)	22 (559)	1.91	(0.87)
4	SW	40A-SW-45	40C-SW-45	4.47 (114)	26 (661)	2.90	(1.32)
4	HW	40A-HW-45	40C-HW-45	4.52 (115)	26 (661)	3.60	(1.63)
5	SW	50A-SW-45	50C-SW-45	5.54 (141)	30 (762)	4.20	(1.91)
5	MW	50A-MW-45	50C-MW-45	5.59 (142)	30 (762)	5.50	(2.50)
5	HW	50A-HW-45	50C-HW-45	5.63 (143)	30 (762)	6.40	(2.91)
6	SW	60A-SW-45	60C-SW-45	6.61 (168)	36 (915)	6.00	(2.72)
6	MW	60A-MW-45	60C-MW-45	6.66 (169)	36 (915)	7.70	(3.50)
6	HW	60A-HW-45	60C-HW-45	6.69 (170)	36 (915)	8.10	(3.68)

Nominal Size	Type	ID Item No.		D	L	Weight	
		Belowground	Aboveground			lbs	kg
2	SW	20B-SW-45	20D-SW-45	2.16 (55)	24 (609)	1.01	(0.46)
2 1/2	SW	25B-SW-45	25C-SW-45	2.66 (68)	24 (609)	1.20	(0.55)
3	SW	30B-SW-45	30D-SW-45	3.16 (80)	36 (914)	1.72	(0.78)
3 1/2	SW	35B-SW-45	35D-SW-45	3.66 (93)	36 (914)	2.10	(0.95)
4	SW	40B-SW-45	40D-SW-45	4.16 (106)	36 (914)	2.70	(1.23)
4	HW	40B-HW-45	40D-HW-45	4.20 (107)	36 (914)	3.40	(1.54)
4 1/2	SW	45B-SW-45	45D-SW-45	4.66 (118)	36 (914)	3.30	(1.50)
4 1/2	HW	45B-HW-45	45D-HW-45	4.70 (119)	36 (914)	4.10	(1.86)
5	SW	50B-SW-45	50D-SW-45	5.16 (131)	48 (1,219)	3.90	(1.77)
5	MW	50B-MW-45	50D-MW-45	5.20 (132)	48 (1,219)	5.00	(2.27)
5	HW	50B-HW-45	50D-HW-45	5.24 (133)	48 (1,219)	5.90	(2.70)
6	SW	60B-SW-45	60D-SW-45	6.16 (156)	60 (1,524)	5.60	(2.54)
6	MW	60B-MW-45	60D-MW-45	6.20 (157)	60 (1,524)	7.20	(3.27)
6	HW	60B-HW-45	60D-HW-45	6.24 (158)	60 (1,524)	8.50	(3.86)

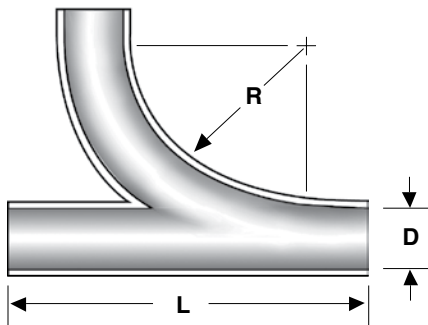

Y - ELBOW

Special fitting not sold in US.

Nominal Size	Type	IPS Item No.		D	R	L	Weight	
		Belowground	Aboveground				lbs	kg
3/4	SW	07A-SW-46-P	07C-SW-46-P	1.06 (27)	24 (609)	12 (305)	0.68	(0.31)
1	SW	10A-SW-46-P	10C-SW-46-P	1.32 (34)	24 (609)	12 (305)	0.75	(0.34)
1 1/4	SW	12A-SW-46-P	12C-SW-46-P	1.67 (42)	24 (609)	12 (305)	0.88	(0.40)
1 1/2	SW	15A-SW-46-P	15C-SW-46-P	1.91 (49)	24 (609)	12 (305)	0.95	(0.43)
2	SW	20A-SW-46-P	20C-SW-46-P	2.40 (61)	24 (609)	24 (609)	1.30	(0.59)
3	SW	30A-SW-46-P	30C-SW-46-P	3.52 (89)	36 (914)	36 (914)	2.40	(1.09)
4	SW	40A-SW-46-P	40C-SW-46-P	4.47 (114)	36 (914)	36 (914)	3.60	(1.63)
4	HW	40A-HW-46-P	40C-HW-46-P	4.52 (115)	36 (914)	36 (914)	4.50	(2.04)
5	SW	50A-SW-46-P	50C-SW-46-P	5.54 (141)	48 (1,219)	48 (1,219)	5.20	(2.36)
5	MW	50A-MW-46-P	50C-MW-46-P	5.59 (142)	48 (1,219)	48 (1,219)	6.90	(3.13)
5	HW	50A-HW-46-P	50C-HW-46-P	5.63 (143)	48 (1,219)	48 (1,219)	8.00	(3.63)
6	SW	60A-SW-46-P	60C-SW-46-P	6.61 (168)	60 (1,524)	60 (1,524)	7.50	(3.41)
6	MW	60A-MW-46-P	60C-MW-46-P	6.66 (169)	60 (1,524)	60 (1,524)	9.60	(4.36)
6	HW	60A-HW-46-P	60C-HW-46-P	6.69 (170)	60 (1,524)	60 (1,524)	10.10	(4.58)

Nominal Size	Type	ID Item No.		D	R	L	Weight	
		Belowground	Aboveground				lbs	kg
2	SW	20B-SW-46-P	20D-SW-46-P	2.16 (55)	24 (609)	24 (609)	1.25	(0.57)
2 1/2	SW	25B-SW-46-P	25D-SW-46-P	2.66 (68)	24 (609)	24 (609)	1.50	(0.68)
3	SW	30B-SW-46-P	30D-SW-46-P	3.16 (80)	36 (914)	36 (914)	2.10	(0.95)
3 1/2	SW	35B-SW-46-P	35D-SW-46-P	3.66 (93)	36 (914)	36 (914)	2.60	(1.18)
4	SW	40B-SW-46-P	40D-SW-46-P	4.16 (106)	36 (914)	36 (914)	3.40	(1.54)
4	HW	40B-HW-46-P	40D-HW-46-P	4.20 (107)	36 (914)	36 (914)	4.20	(1.91)
4 1/2	SW	45B-SW-46-P	45D-SW-46-P	4.66 (118)	36 (914)	36 (914)	4.10	(1.86)
4 1/2	HW	45B-HW-46-P	45D-HW-46-P	4.70 (119)	36 (914)	36 (914)	5.10	(2.32)
5	SW	50B-SW-46-P	50D-SW-46-P	5.16 (131)	48 (1,219)	48 (1,219)	4.90	(2.23)
5	MW	50B-MW-46-P	50D-MW-46-P	5.20 (132)	48 (1,219)	48 (1,219)	6.20	(2.82)
5	HW	50B-HW-46-P	50D-HW-46-P	5.24 (133)	48 (1,219)	48 (1,219)	7.40	(3.36)
6	SW	60B-SW-46-P	60D-SW-46-P	6.16 (156)	60 (1,524)	60 (1,524)	7.00	(3.18)
6	MW	60B-MW-46-P	60D-MW-46-P	6.20 (157)	60 (1,524)	60 (1,524)	9.00	(4.09)
6	HW	60B-HW-46-P	60D-HW-46-P	6.24 (158)	60 (1,524)	60 (1,524)	10.60	(4.81)