

## NON-METALLIC U-BOLT

U-Bolts are made from a fiberglass reinforced urethane material and are recommended for temperatures ranging from -40°F to +150°F.

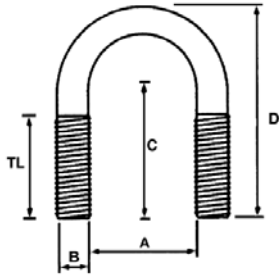

Part No.	Pipe Nominal Dia.	Dimensions					Load Ratings	
		A in. (mm)	B in. (mm)	C in. (mm)	D in. (mm)	TL in. (mm)	Max. Rec. Load lbs. (kg)	Max. Rec. Torque in. lbs. (Nm)
CS-UB-1/2	1/2"	0.93 (24)	0.375 (10)	1.56 (40)	2.41 (61)	1.25 (32)	75 (34)	20 (2.3)
CS-UB-3/4	3/4"	1.12 (28)	0.375 (10)	1.66 (42)	2.60 (66)	1.25 (32)	75 (34)	20 (2.3)
CS-UB-1	1"	1.37 (35)	0.375 (10)	1.78 (45)	2.85 (72)	1.25 (32)	75 (34)	20 (2.3)
CS-UB-1.25	1 1/4"	1.68 (43)	0.375 (10)	1.94 (49)	3.16 (80)	1.25 (32)	75 (34)	20 (2.3)
CS-UB-1.50	1 1/2"	2.00 (51)	0.375 (10)	2.10 (53)	3.47 (88)	1.25 (32)	75 (34)	20 (2.3)
CS-UB-2	2"	2.43 (62)	0.500 (13)	2.46 (62)	4.18 (106)	1.50 (38)	150 (68)	40 (4.5)
CS-UB-2.5	2 1/2"	2.93 (74)	0.500 (13)	2.71 (69)	4.68 (119)	1.50 (38)	150 (68)	40 (4.5)
CS-UB-3	3"	3.56 (90)	0.500 (13)	3.03 (77)	5.31 (135)	1.50 (38)	150 (68)	40 (4.5)
CS-UB-3.5	3 1/2"	4.06 (103)	0.500 (13)	3.28 (83)	5.81 (148)	1.50 (38)	150 (68)	40 (4.5)
CS-UB-4	4"	4.56 (116)	0.500 (13)	3.53 (90)	6.31 (160)	1.50 (38)	150 (68)	40 (4.5)

## UNIVERSAL INSTRUMENT PIPE SUPPORT

The universal instrument pipe support system is manufactured from 2" filament wound epoxy resin conduit for increased stiffness and corrosion resistance. The outside diameter is 2 3/8" which is identical to 2" steel pipe (or PVC). The system is non-conductive and resistant to sunlight. The base is made from vinyl ester resin, with an 8" square base, specially designed with side bracing for extra bending support. The instrument pipe support is delivered fully assembled, or available in individual components if so desired. The 2" non-metallic u-bolt is an excellent device for attaching instruments, gauges etc. (Shaded components not included.)

### SINGLE FLOOR MOUNT

Catalog No.: CS-IS1- (dim) A  
(Where A is defined per sketch below.)

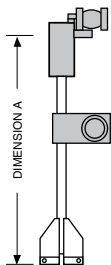

### WALL OR FLOOR MOUNT

Catalog No.: CS-IS2- (dim) A - (dim) B

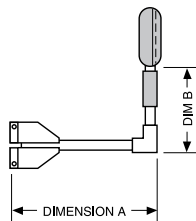

### DOUBLE FLOOR MOUNT

Catalog No.: CS-IS3- (dim) A - (dim) B - (dim) C

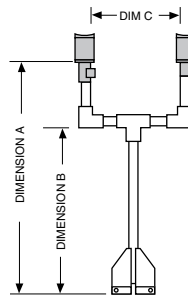

### MULTIPLE INSTRUMENT FLOOR MOUNT

Catalog No.: CS-IS4- (dim) A - (dim) B - (dim) C

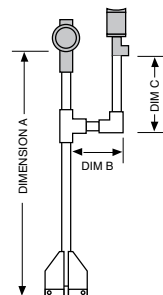

## PUSHBUTTON STATION

Similar to the instrument pipe support system, with 2" vinyl ester square tubing. The base is made from vinyl ester resin, with an 8" square base, specially designed with side bracing for extra bending support.

Catalog No.: CS-PB- (dim) A - (dim) B - (dim) C

