

END BELLS-SOCKET TYPE

End bells are used for creating a permanent termination into a box as well as having a smooth surface that the cable can be pulled over.

Nominal Size	Type	IPS Item No.		D1	D2	L	M	B	Weight	
		Belowground	Aboveground						lbs	kg
¾	SW	07A-SW-29	07C-SW-29	1.06 (27)	1.20 (30)	1.60 (41)	1.50 (38)	0.25 (6)	0.10 (0.05)	
1	SW	10A-SW-29	10C-SW-29	1.32 (34)	1.46 (37)	1.60 (41)	2.50 (64)	0.50 (13)	0.10 (0.05)	
1¼	SW	12A-SW-29	12C-SW-29	1.67 (42)	1.81 (46)	1.60 (41)	3.00 (76)	0.50 (13)	0.15 (0.07)	
1½	SW	15A-SW-29	15C-SW-29	1.91 (49)	2.04 (52)	1.60 (41)	3.25 (83)	0.50 (13)	0.20 (0.09)	
2	SW	20A-SW-29	20C-SW-29	2.40 (61)	2.54 (61)	3.00 (76)	3.75 (95)	0.50 (13)	0.40 (0.18)	
3	SW	30A-SW-29	30C-SW-29	3.52 (89)	3.66 (93)	3.00 (76)	5.37 (137)	0.50 (13)	0.45 (0.20)	
4	SW	40A-SW-29	40C-SW-29	4.47 (114)	4.61 (117)	3.00 (76)	6.50 (165)	0.75 (19)	0.80 (0.36)	
4	HW	40A-HW-29	40C-HW-29	4.52 (115)	4.69 (119)	3.00 (76)	6.50 (165)	0.75 (19)	0.85 (0.38)	
5	SW	50A-SW-29	50C-SW-29	5.54 (141)	5.68 (144)	3.00 (76)	7.37 (187)	0.75 (19)	0.90 (0.41)	
5	MW	50A-MW-29	50C-MW-29	5.59 (142)	5.79 (147)	3.00 (76)	7.37 (187)	0.75 (19)	0.95 (0.43)	
5	HW	50A-HW-29	50C-HW-29	5.63 (143)	5.85 (149)	3.00 (76)	7.37 (187)	0.75 (19)	1.00 (0.45)	
6	SW	60A-SW-29	60C-SW-29	6.61 (168)	6.68 (170)	3.00 (76)	8.50 (216)	0.75 (19)	1.05 (0.48)	
6	MW	60A-MW-29	60C-MW-29	6.66 (169)	6.79 (172)	3.00 (76)	8.50 (216)	0.75 (19)	1.10 (0.50)	
6	HW	60A-HW-29	60C-HW-29	6.69 (170)	6.85 (174)	3.00 (76)	8.50 (216)	0.75 (19)	1.15 (0.52)	

Nominal Size	Type	ID Item No.		D1	D2	L	M	B	Weight	
		Belowground	Aboveground						lbs	kg
2	SW	20B-SW-29	20D-SW-29	2.16 (55)	2.30 (58)	3.00 (76)	3.62 (92)	0.50 (13)	0.40 (0.18)	
2½	SW	25B-SW-29	25D-SW-29	2.66 (68)	2.80 (71)	3.00 (76)	4.00 (102)	0.50 (13)	0.45 (0.20)	
3	SW	30B-SW-29	30D-SW-29	3.16 (80)	3.30 (84)	3.00 (76)	5.00 (127)	0.50 (13)	0.55 (0.25)	
3½	SW	35B-SW-29	35D-SW-29	3.66 (93)	3.80 (96)	3.00 (76)	5.50 (140)	0.50 (13)	0.60 (0.27)	
4	SW	40B-SW-29	40D-SW-29	4.16 (106)	4.30 (109)	3.00 (76)	6.00 (153)	0.75 (19)	0.78 (0.35)	
4	HW	40B-HW-29	40D-HW-29	4.20 (107)	4.39 (111)	3.00 (76)	6.00 (153)	0.75 (19)	0.95 (0.43)	
5	SW	50B-SW-29	50D-SW-29	5.16 (131)	5.30 (135)	3.00 (76)	7.00 (178)	0.75 (19)	0.80 (0.36)	
5	MW	50B-MW-29	50D-MW-29	5.20 (132)	5.39 (137)	3.00 (76)	7.00 (178)	0.75 (19)	0.85 (0.39)	
5	HW	50B-HW-29	50D-HW-29	5.24 (133)	5.42 (138)	3.00 (76)	7.00 (178)	0.75 (19)	0.87 (0.40)	
6	SW	60B-SW-29	60D-SW-29	6.16 (156)	6.30 (160)	3.00 (76)	8.00 (203)	0.75 (19)	0.95 (0.43)	
6	MW	60B-MW-29	60D-MW-29	6.20 (157)	6.39 (162)	3.00 (76)	8.00 (203)	0.75 (19)	1.15 (0.52)	
6	HW	60B-HW-29	60D-HW-29	6.24 (158)	6.42 (163)	3.00 (76)	8.00 (203)	0.75 (19)	1.25 (0.57)	

Nominal Size	Type	Item No.		D1	D2	L	M	B	Weight	
		Belowground	Aboveground						lbs	kg
2	XW	20B-XW-29	20D-XW-29	2.520 (64)	3.020 (76)	3.00 (76)	3.62 (92)	0.50 (13)	1.30 (0.59)	
2½	XW	25B-XW-29	25D-XW-29	3.025 (77)	3.525 (90)	3.00 (76)	4.00 (102)	0.50 (13)	1.59 (0.72)	
3	XW	30B-XW-29	30D-XW-29	3.520 (89)	4.020 (102)	3.00 (76)	5.00 (127)	0.50 (13)	1.90 (0.86)	
3½	XW	35B-XW-29	35D-XW-29	4.025 (102)	4.525 (115)	3.00 (76)	5.50 (140)	0.50 (13)	2.17 (0.98)	
4	XW	40B-XW-29	40D-XW-29	4.520 (115)	5.020 (128)	5.00 (127)	6.00 (153)	0.75 (19)	2.40 (1.09)	
5	XW	50B-XW-29	50D-XW-29	5.520 (140)	6.020 (153)	5.00 (127)	7.00 (178)	0.75 (19)	2.42 (1.10)	
6	XW	60B-XW-29	60D-XW-29	6.520 (166)	7.020 (178)	5.00 (127)	8.00 (203)	0.75 (19)	2.50 (1.13)	

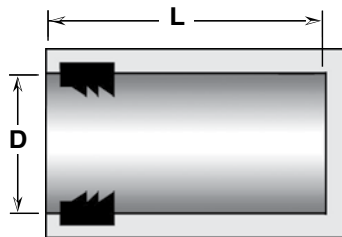

FIBERGLASS END CAP WITH GASKET

Nominal Size	Type	IPS Item No.		D	L	Weight	
		Belowground	Aboveground			lbs	kg
2	SW	20A-SW-23-G	20C-SW-23-G	2.40 (61)	4 (102)	0.70 (0.32)	
3	SW	30A-SW-23-G	30C-SW-23-G	3.52 (89)	4 (102)	0.95 (0.43)	
4	SW	40A-SW-23-G	40C-SW-23-G	4.47 (114)	4 (102)	1.30 (0.59)	
4	HW	40A-HW-23-G	40C-HW-23-G	4.52 (115)	4 (102)	1.40 (0.64)	
5	SW	50A-SW-23-G	50C-SW-23-G	5.54 (141)	4 (102)	1.60 (0.73)	
5	MW	50A-MW-23-G	50C-MW-23-G	5.59 (142)	4 (102)	1.80 (0.82)	
5	HW	50A-HW-23-G	50C-HW-23-G	5.63 (143)	4 (102)	1.90 (0.86)	
6	SW	60A-SW-23-G	60C-SW-23-G	6.61 (168)	4 (102)	2.00 (0.91)	
6	MW	60A-MW-23-G	60C-MW-23-G	6.66 (169)	4 (102)	2.10 (0.95)	
6	HW	60A-HW-23-G	60C-HW-23-G	6.69 (170)	4 (102)	2.40 (1.09)	

Nominal Size	Type	ID Item No.		D	L	Weight	
		Belowground	Aboveground			lbs	kg
2	SW	20B-SW-23-G	20D-SW-23-G	2.16 (55)	4 (102)	0.70 (0.32)	
2½	SW	25B-SW-23-G	25D-SW-23-G	2.66 (68)	4 (102)	0.80 (0.36)	
3	SW	30B-SW-23-G	30D-SW-23-G	3.16 (80)	4 (102)	0.95 (0.43)	
3½	HW	35B-SW-23-G	35D-SW-23-G	3.66 (93)	4 (102)	1.20 (0.55)	
4	SW	40B-SW-23-G	40D-SW-23-G	4.16 (106)	4 (102)	1.30 (0.59)	
4	HW	40B-HW-23-G	40D-HW-23-G	4.20 (107)	4 (102)	1.40 (0.64)	
4½	SW	45B-SW-23-G	45D-SW-23-G	4.66 (118)	4 (102)	1.50 (0.68)	
4½	HW	45B-HW-23-G	45D-HW-23-G	4.70 (119)	4 (102)	1.60 (0.73)	
5	SW	50B-SW-23-G	50D-SW-23-G	5.16 (131)	4 (102)	1.60 (0.73)	
5	MW	50B-MW-23-G	50D-MW-23-G	5.20 (132)	4 (102)	1.70 (0.77)	
5	HW	50B-HW-23-G	50D-HW-23-G	5.24 (133)	4 (102)	1.80 (0.82)	
6	SW	60B-SW-23-G	60D-SW-23-G	6.16 (156)	4 (102)	1.90 (0.86)	
6	MW	60B-MW-23-G	60D-MW-23-G	6.20 (157)	4 (102)	1.90 (0.86)	
6	HW	60B-HW-23-G	60D-HW-23-G	6.24 (158)	4 (102)	2.00 (0.91)	