

SLEEVE COUPLING WITH GASKET

Nominal Size	Type	IPS Item No.		D	L	Weight	
		Belowground	Aboveground			lbs	kg
¾	SW	07A-SW-42-G	07C-SW-42-G	1.06 (27)	8 (203)	0.06	(0.03)
1	SW	10A-SW-42-G	10C-SW-42-G	1.32 (34)	8 (203)	0.08	(0.04)
1¼	SW	12A-SW-42-G	12C-SW-42-G	1.67 (42)	8 (203)	0.10	(0.05)
1½	SW	15A-SW-42-G	15C-SW-42-G	1.91 (49)	8 (203)	0.11	(0.05)
2	SW	20A-SW-42-G	20C-SW-42-G	2.40 (61)	8 (203)	0.70	(0.32)
3	SW	30A-SW-42-G	30C-SW-42-G	3.52 (89)	8 (203)	0.95	(0.43)
4	SW	40A-SW-42-G	40C-SW-42-G	4.47 (114)	8 (203)	1.30	(0.59)
4	HW	40A-HW-42-G	40C-HW-42-G	4.52 (115)	8 (203)	1.40	(0.64)
5	SW	50A-SW-42-G	50C-SW-42-G	5.54 (141)	8 (203)	1.60	(0.73)
5	MW	50A-MW-42-G	50C-MW-42-G	5.59 (142)	8 (203)	1.80	(0.82)
5	HW	50A-HW-42-G	50C-HW-42-G	5.63 (143)	8 (203)	1.90	(0.86)
6	SW	60A-SW-42-G	60C-SW-42-G	6.61 (168)	8 (203)	2.00	(0.91)
6	MW	60A-MW-42-G	60C-MW-42-G	6.66 (169)	8 (203)	2.10	(0.95)
6	HW	60A-HW-42-G	60C-HW-42-G	6.69 (170)	8 (203)	2.40	(1.09)

Nominal Size	Type	ID Item No.		D	L	Weight	
		Belowground	Aboveground			lbs	kg
2	SW	20B-SW-42-G	20D-SW-42-G	2.16 (55)	8 (203)	0.70	(0.32)
2½	SW	25B-SW-42-G	25D-SW-42-G	2.66 (68)	8 (203)	0.80	(0.36)
3	SW	30B-SW-42-G	30D-SW-42-G	3.16 (80)	8 (203)	0.95	(0.43)
3½	SW	35B-SW-42-G	35D-SW-42-G	3.66 (93)	8 (203)	1.20	(0.55)
4	SW	40B-SW-42-G	40D-SW-42-G	4.16 (106)	8 (203)	1.30	(0.59)
4	HW	40B-HW-42-G	40D-HW-42-G	4.20 (107)	8 (203)	1.40	(0.64)
4½	SW	45B-SW-42-G	45D-SW-42-G	4.66 (118)	8 (203)	1.50	(0.68)
4½	HW	45B-HW-42-G	45D-HW-42-G	4.70 (119)	8 (203)	1.60	(0.73)
5	SW	50B-SW-42-G	50D-SW-42-G	5.16 (131)	8 (203)	1.60	(0.73)
5	MW	50B-MW-42-G	50D-MW-42-G	5.20 (132)	8 (203)	1.70	(0.77)
5	HW	50B-HW-42-G	50D-HW-42-G	5.24 (133)	8 (203)	1.80	(0.82)
6	SW	60B-SW-42-G	60D-SW-42-G	6.16 (156)	8 (203)	1.90	(0.86)
6	MW	60B-MW-42-G	60D-MW-42-G	6.20 (157)	8 (203)	1.90	(0.86)
6	HW	60B-HW-42-G	60D-HW-42-G	6.24 (158)	8 (203)	2.00	(0.91)

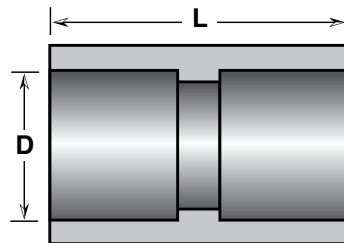

STOP COUPLING

Stop coupling is sometimes referred to as a double bell coupling.

Nominal Size	Type	IPS Item No.		D	L	Weight	
		Belowground	Aboveground			lbs	kg
¾	SW	07A-SW-40	07C-SW-40	1.06 (27)	6 (152)	0.07	(0.03)
1	SW	10A-SW-40	10C-SW-40	1.32 (34)	6 (152)	0.08	(0.04)
1¼	SW	12A-SW-40	12C-SW-40	1.67 (42)	6 (152)	0.09	(0.04)
1½	SW	15A-SW-40	15C-SW-40	1.91 (49)	6 (152)	0.11	(0.05)
2	SW	20A-SW-40	20C-SW-40	2.40 (61)	6 (152)	0.20	(0.10)
3	SW	30A-SW-40	30C-SW-40	3.52 (89)	6 (152)	0.30	(0.14)
4	SW	40A-SW-40	40C-SW-40	4.47 (114)	6 (152)	0.43	(0.20)
4	HW	40A-HW-40	40C-HW-40	4.52 (115)	6 (152)	0.58	(0.26)
5	SW	50A-SW-40	50C-SW-40	5.54 (141)	6 (152)	0.50	(0.23)
5	MW	50A-MW-40	50C-MW-40	5.59 (142)	6 (152)	0.70	(0.31)
5	HW	50A-HW-40	50C-HW-40	5.63 (143)	6 (152)	0.90	(0.41)
6	SW	60A-SW-40	60C-SW-40	6.61 (168)	6 (152)	0.65	(0.30)
6	MW	60A-MW-40	60C-MW-40	6.66 (169)	6 (152)	0.85	(0.39)
6	HW	60A-HW-40	60C-HW-40	6.69 (170)	6 (152)	0.95	(0.43)

Nominal Size	Type	ID Item No.		D	L	Weight	
		Belowground	Aboveground			lbs	kg
2	SW	20B-SW-40	20D-SW-40	2.16 (55)	6 (152)	0.20	(0.09)
2½	SW	25B-SW-40	25D-SW-40	2.66 (68)	6 (152)	0.25	(0.11)
3	SW	30B-SW-40	30D-SW-40	3.16 (80)	6 (152)	0.30	(0.14)
3½	SW	35B-SW-40	35D-SW-40	3.66 (93)	6 (152)	0.35	(0.16)
4	SW	40B-SW-40	40D-SW-40	4.16 (106)	6 (152)	0.40	(0.18)
4	HW	40B-HW-40	40D-HW-40	4.20 (107)	6 (152)	0.54	(0.25)
4½	SW	45B-SW-40	45D-SW-40	4.66 (118)	6 (152)	0.45	(0.20)
4½	HW	45B-HW-40	45D-HW-40	4.70 (119)	6 (152)	0.60	(0.27)
5	SW	50B-SW-40	50D-SW-40	5.16 (131)	6 (152)	0.50	(0.23)
5	MW	50B-MW-40	50D-MW-40	5.20 (132)	6 (152)	0.68	(0.31)
5	HW	50B-HW-40	50D-HW-40	5.24 (133)	6 (152)	0.80	(0.36)
6	SW	60B-SW-40	60D-SW-40	6.16 (156)	6 (152)	0.60	(0.27)
6	MW	60B-MW-40	60D-MW-40	6.20 (157)	6 (152)	0.80	(0.36)
6	HW	60B-HW-40	60D-HW-40	6.24 (158)	6 (152)	0.92	(0.42)

Nominal Size	Type	Item No.		D	L	Weight	
		Belowground	Aboveground			lbs	kg
2	XW	20B-XW-40	20D-XW-40	2.520 (64)	6 (152)	0.65	(0.29)
2½	XW	25B-XW-40	25D-XW-40	3.025 (77)	6 (152)	0.77	(0.35)
3	XW	30B-XW-40	30D-XW-40	3.520 (89)	6 (152)	0.95	(0.43)
3½	XW	35B-XW-40	35D-XW-40	4.025 (102)	6 (152)	1.12	(0.51)
4	XW	40B-XW-40	40D-XW-40	4.520 (115)	10 (254)	2.00	(0.91)
5	XW	50B-XW-40	50D-XW-40	5.520 (140)	10 (254)	2.50	(1.13)
6	XW	60B-XW-40	60D-XW-40	6.520 (166)	10 (254)	2.90	(1.32)